

PIVOT DOOR

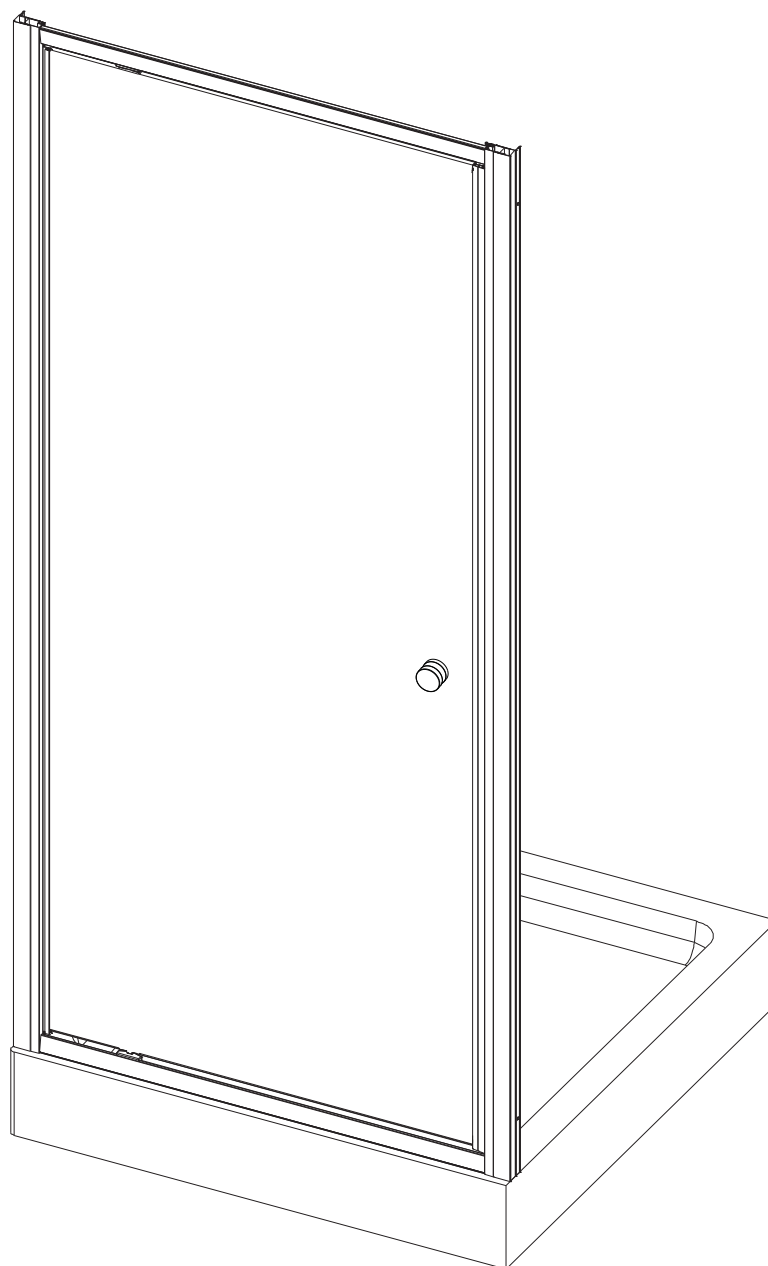

INSTALLATION GUIDE

Size	Product code	Adjustment	Opening space
760	A1206B0	710-750	490
800	A1206D0	750-790	530
900	A1206E0	850-890	630

ATTENTION

If you install the product in a way that differs from this manual this will void all guarantees. Before installation check that the product meets all your requirements and is not damaged. By proceeding with installation, You accept the condition of the product. The wall plugs supplied with the installation kit are for use in solid walls. Hollow or 'stud partition' walls will require alternative fixings. Please consult your local hardware supplier for the correct type.

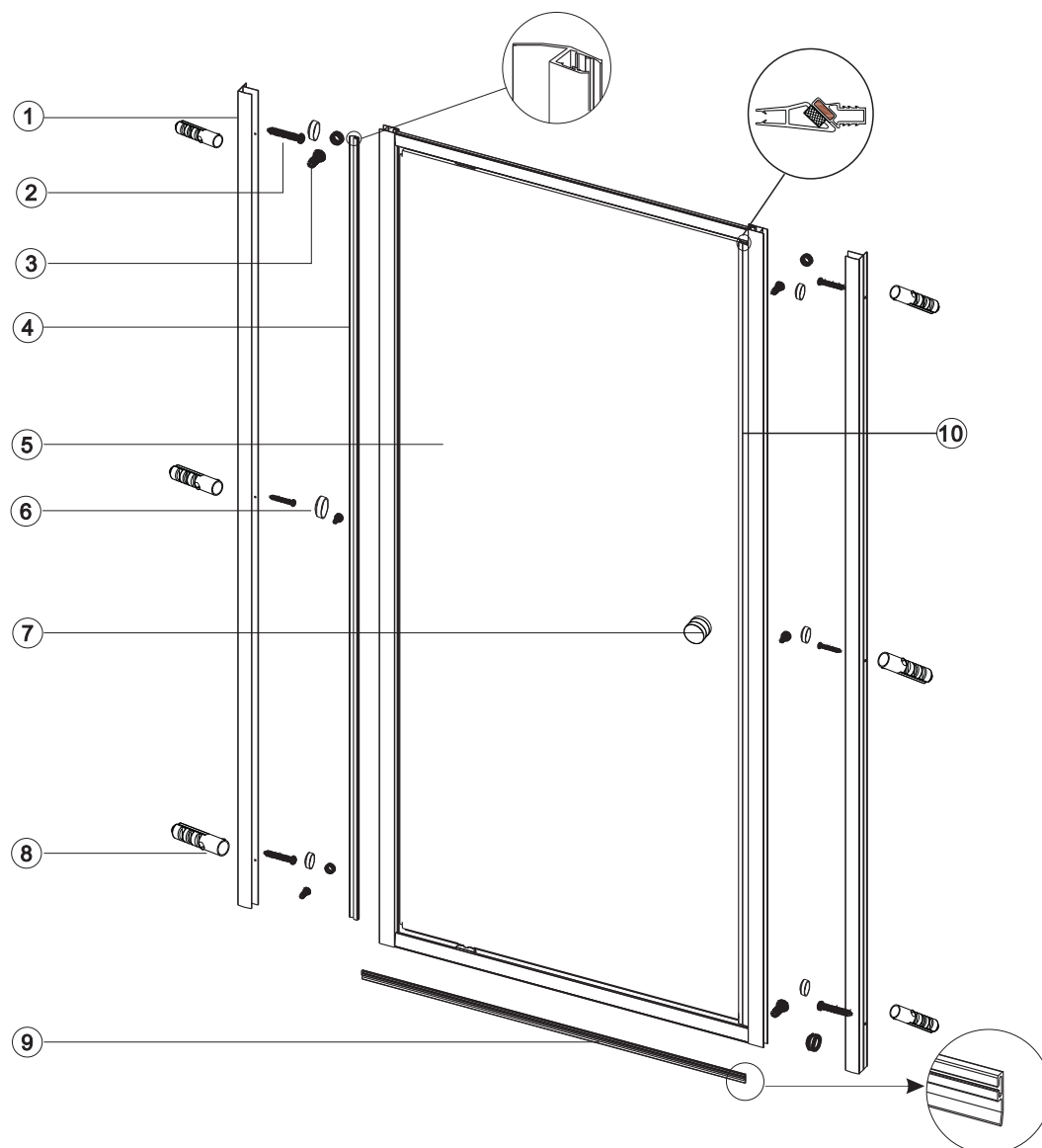

NO.	Qty	Part No.
1	2	A02S0020
2	6	2SY51
3	6	2SY50
4	1	A02S0033
5	1	A

NO.	Qty	Part No.
6	12	C070
7	1	A12S0023
8	6	2SP12
9	1	C055
10	1	A02S0040

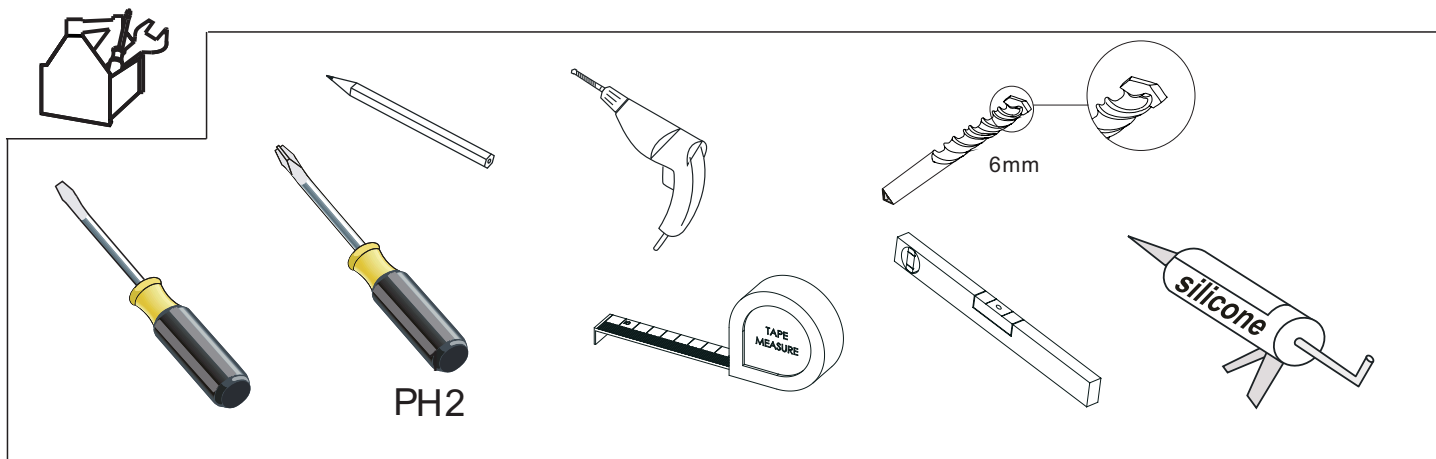
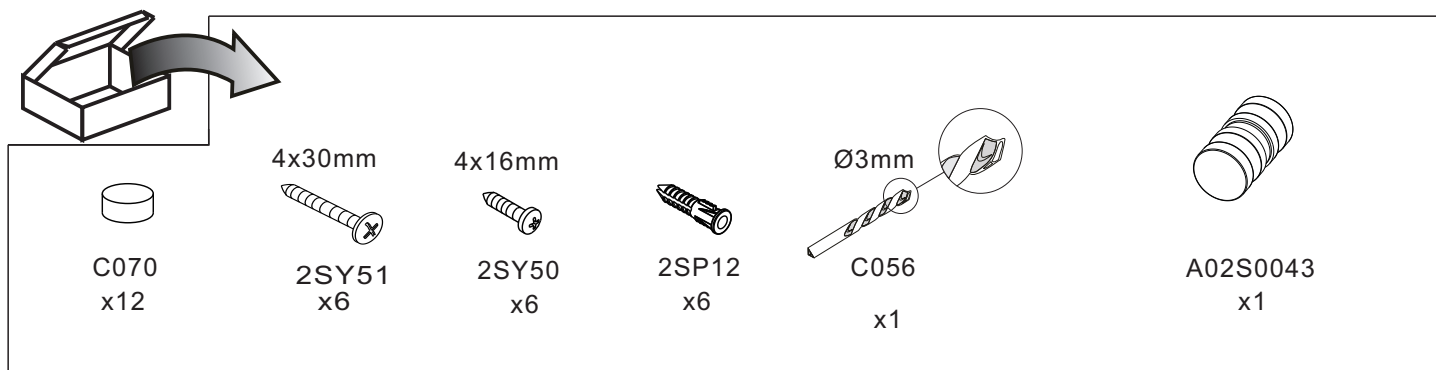

Please ensure your tray is 100% level in all directions before you fit your enclosure

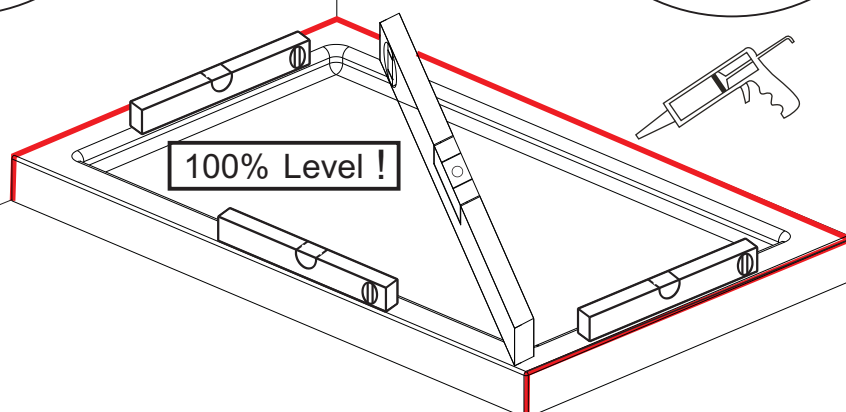
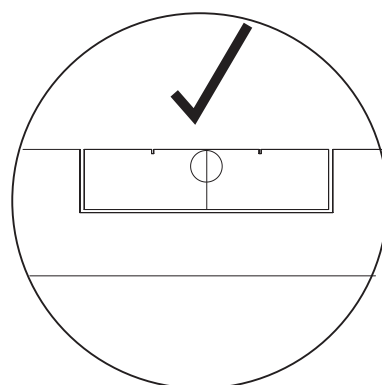
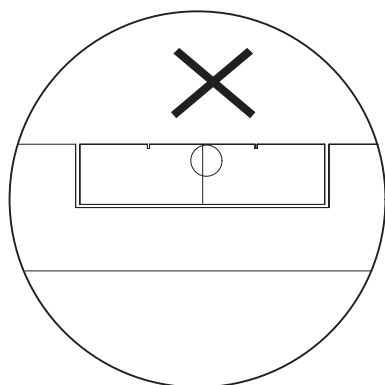

1

Determine your step in from the edge of the tray. Measure your x and y dimension. Your measurements must fall within the below table of adjustments marked as X.

Level your wall profiles and mark the points of fixing.

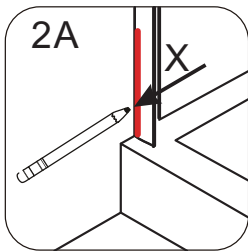

CODE	X
A1206B0	710-750
A1206D0	750-790
A1206E0	850-890

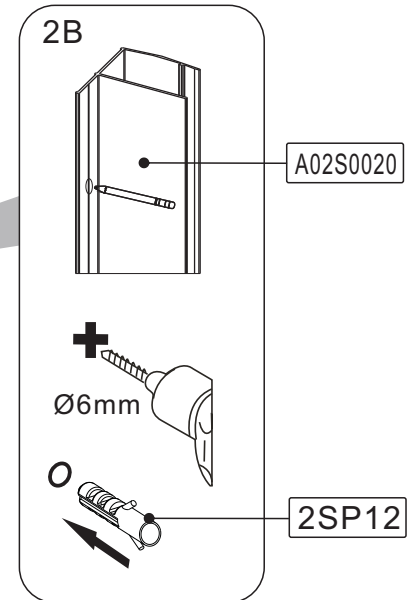
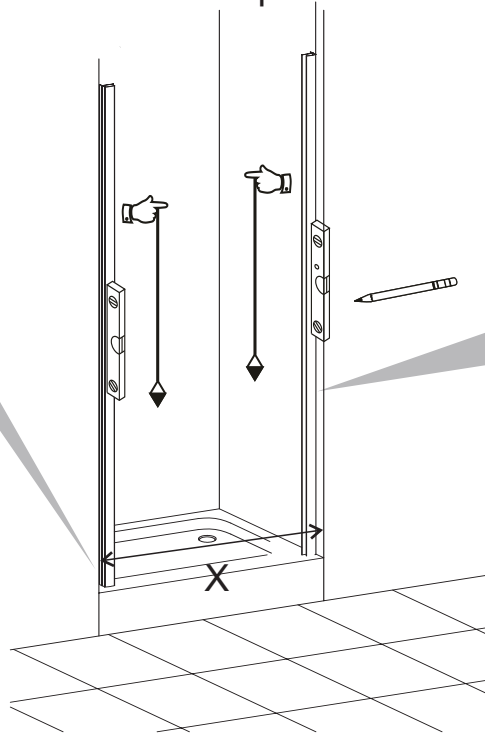

2

When fitting a fully framed product into a recess you must push the wall profiles onto the uprights. This is done as fitting the wall profiles first in a tight recess may lead to difficulty later when fitting the door.

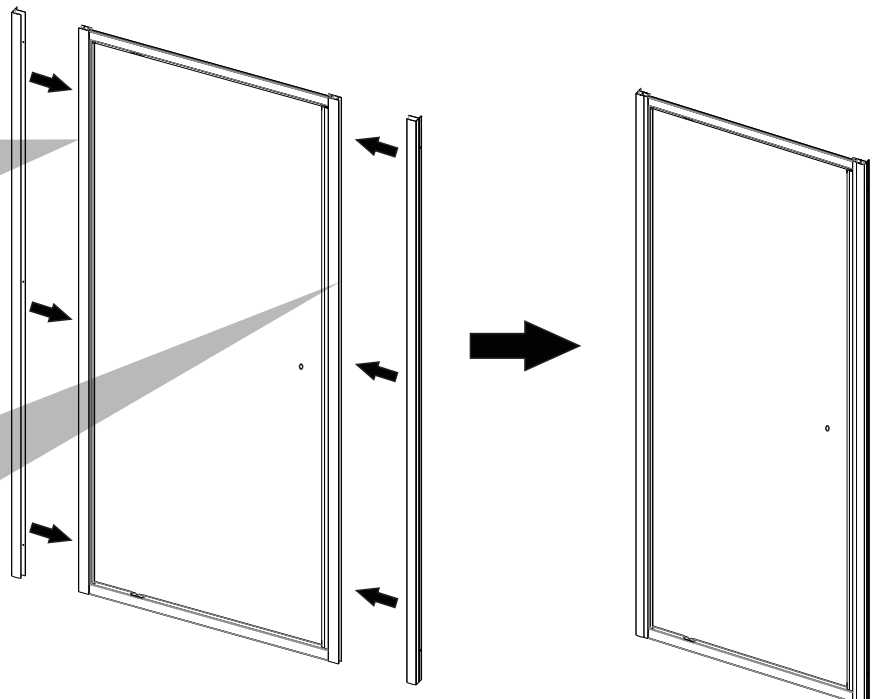
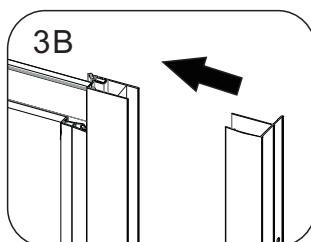
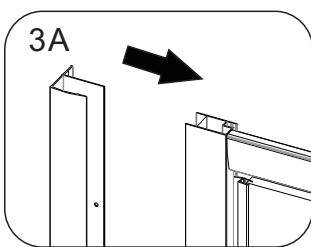

3

When the enclosure is between your two walls you can then fix your wall profiles to the walls using the fixing screws provided. Equalise the gaps on either side of the upright profiles and fix using 2SY50 as shown in 4C. Also make sure that the Gaps shown in 4D are equal.

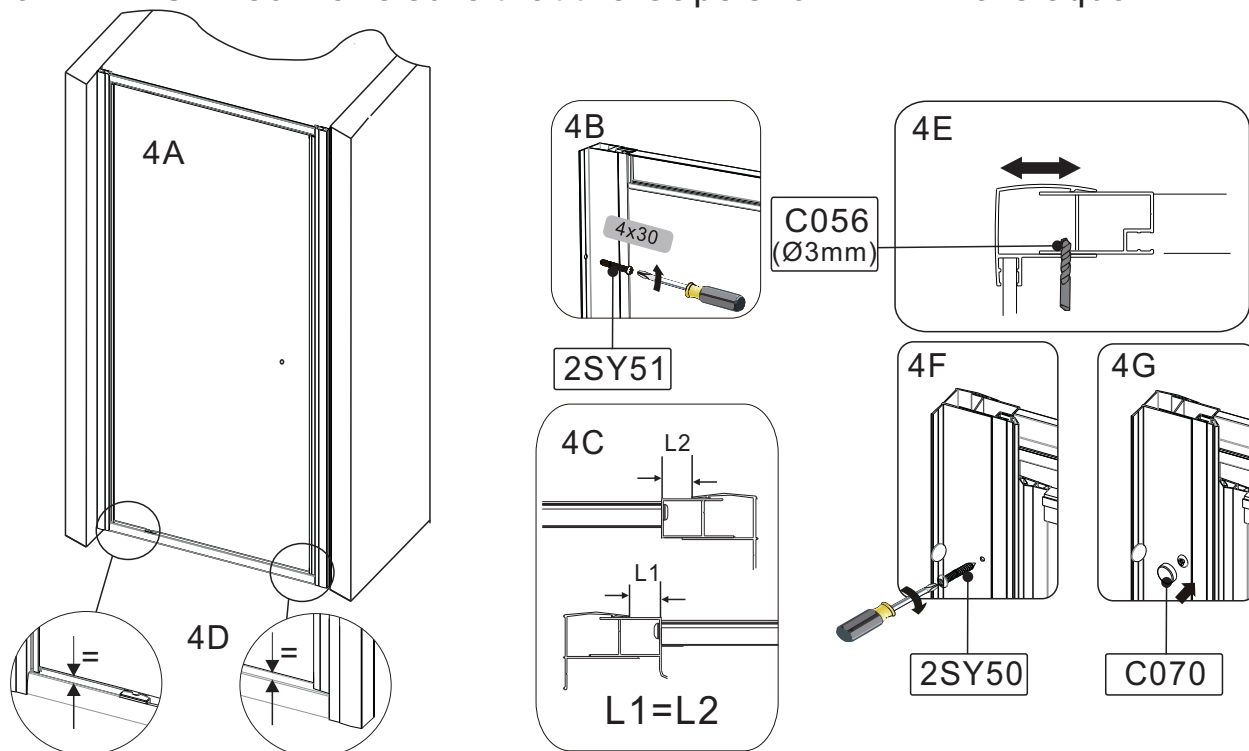

4

Fit your back side closing seal along with your bottom seal as shown in 5C and 5D. Add a small amount of silicone to the bottom seal to stop it for moving along the bottom profile.

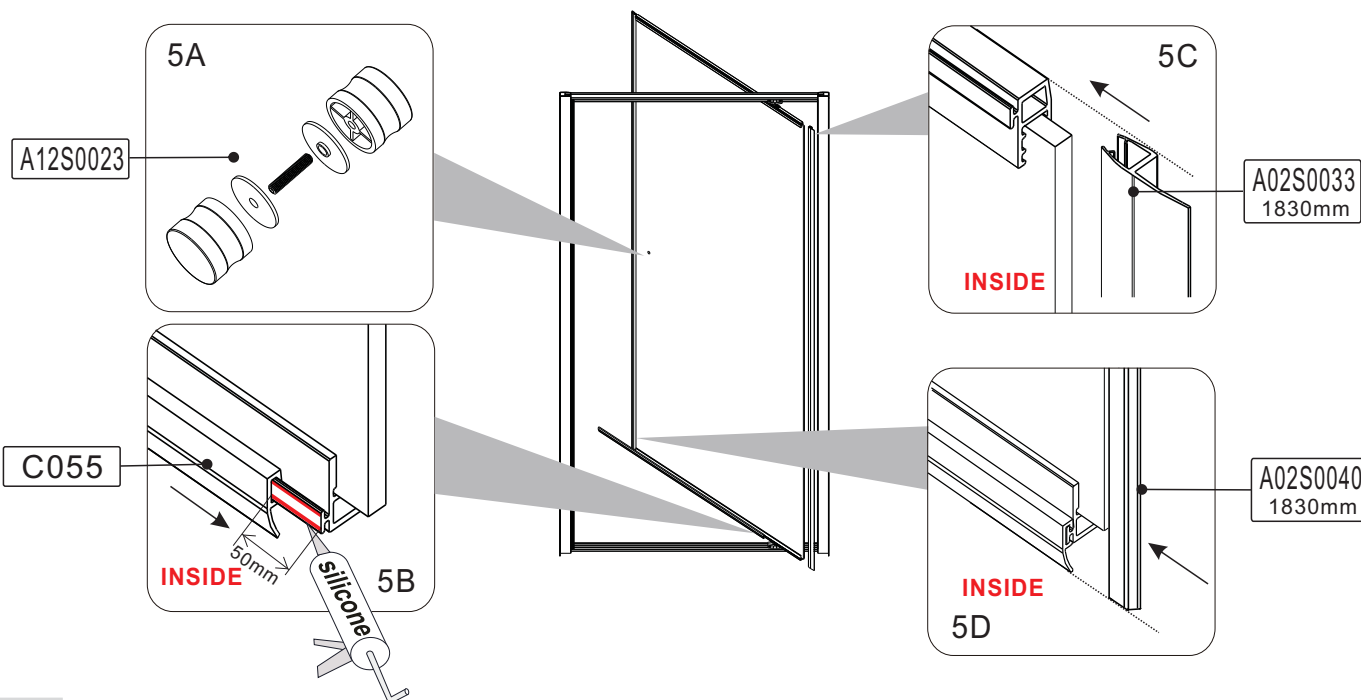

5

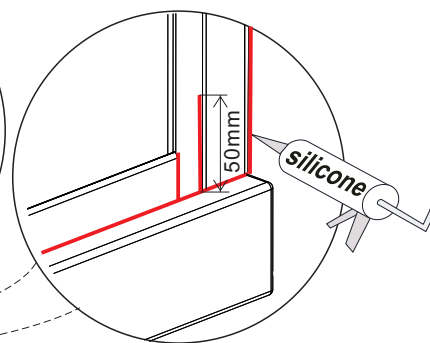
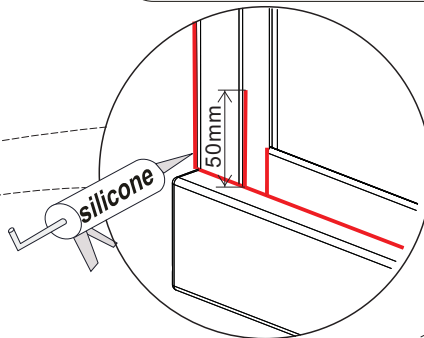
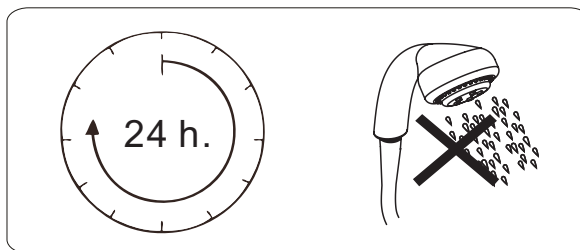
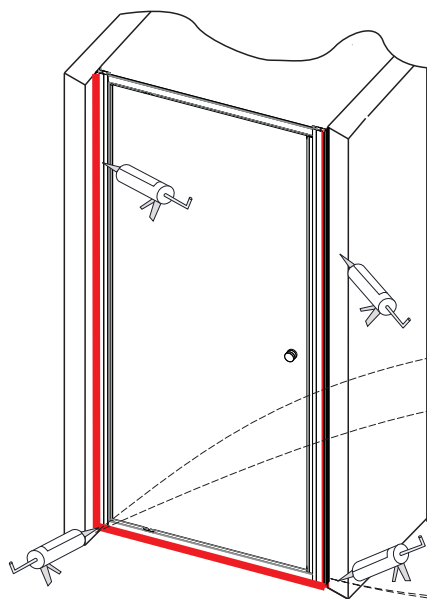

6

CE

Merlyn Industries Ltd (MER09)
Purcellsinch, Kilkenny, IRL.

15

EN 14428

Shower enclosures with aluminium
profiles and safety glass

Cleanability : Pass

Impact resistance/
shatter properties : Pass

Durability : Pass

SIDE PANEL

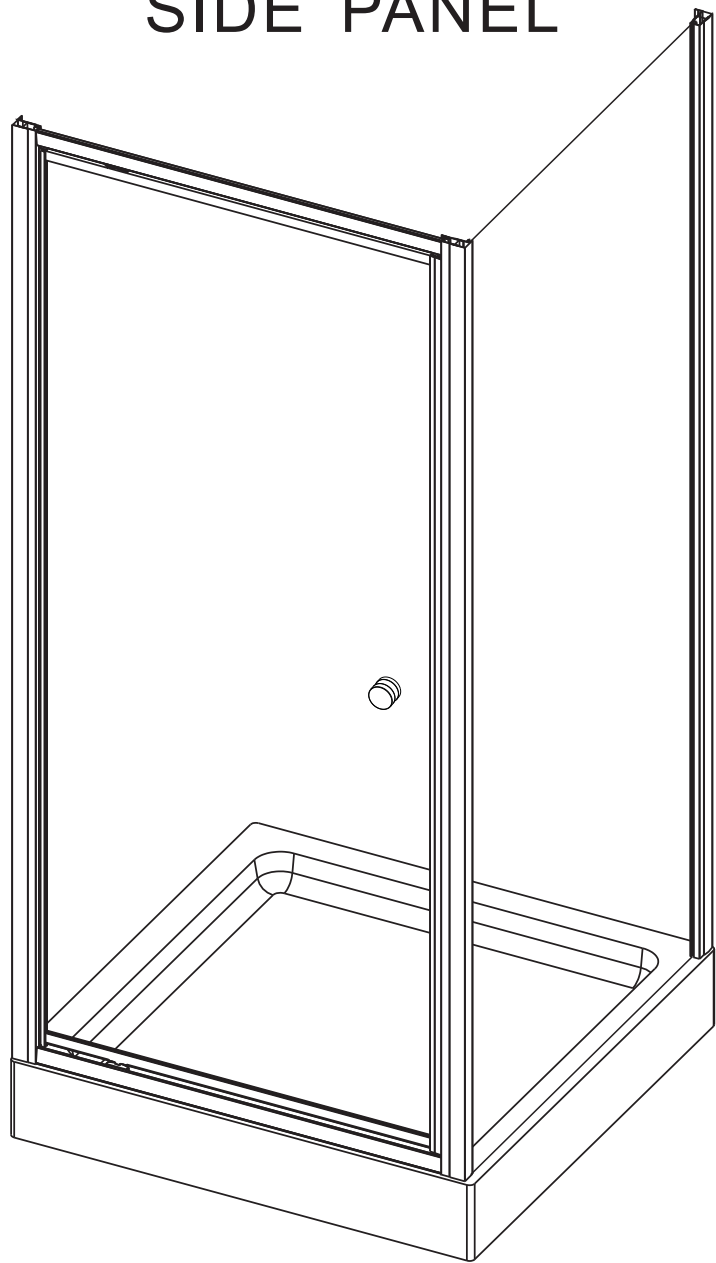

INSTALLATION GUIDE

Size	Product code	Adjustment
760	A1207B0	730–750
800	A1207D0	770–790
900	A1207E0	870–890

ATTENTION

If you install the product in a way that differs from this manual this will void all guarantees. Before installation check that the product meets all your requirements and is not damaged. By proceeding with installation, You accept the condition of the product. The wall plugs supplied with the installation kit are for use in solid walls. Hollow or 'stud partition' walls will require alternative fixings. Please consult your local hardware supplier for the correct type.

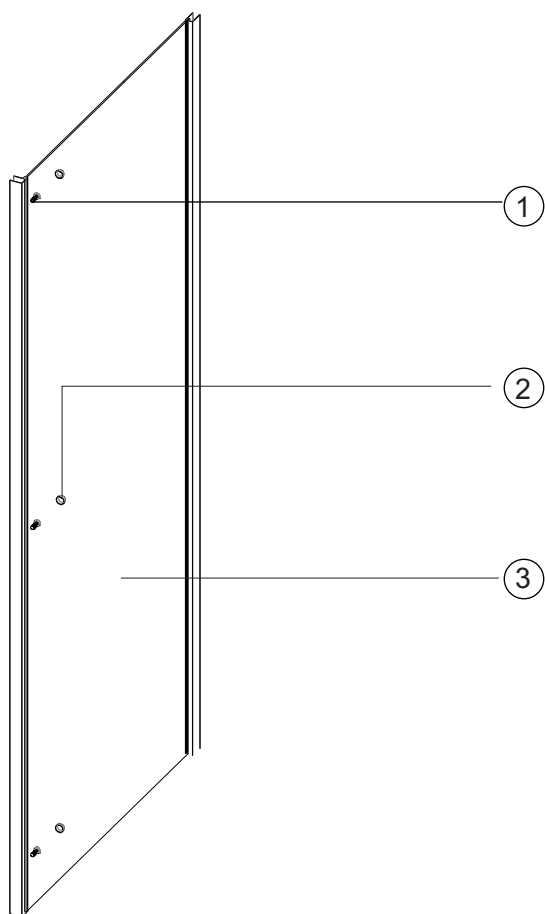

No.	Qty	Part No
1	3	2SY50
2	3	C070
3	1	A

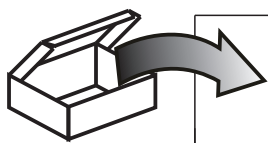

C070
x3

4X16mm



2SY50
x3

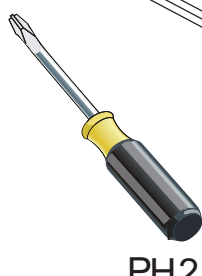

PH2

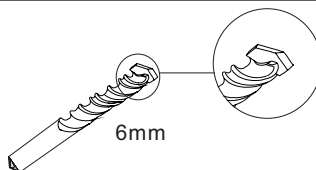
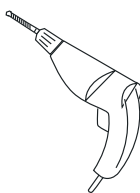
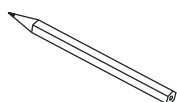

6mm

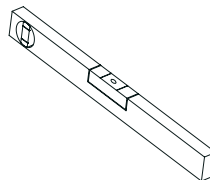
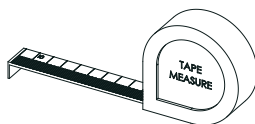

Please ensure your tray is 100% level in all directions before fitting your enclosure.

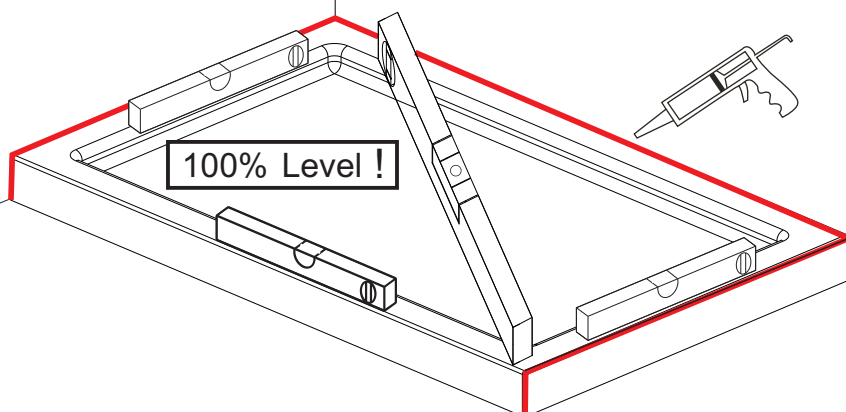
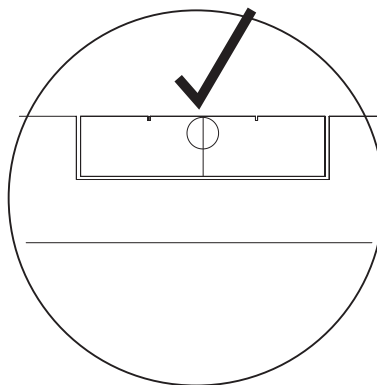
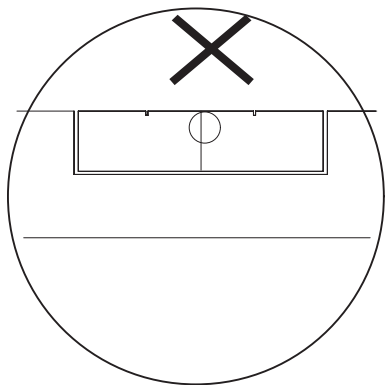

1

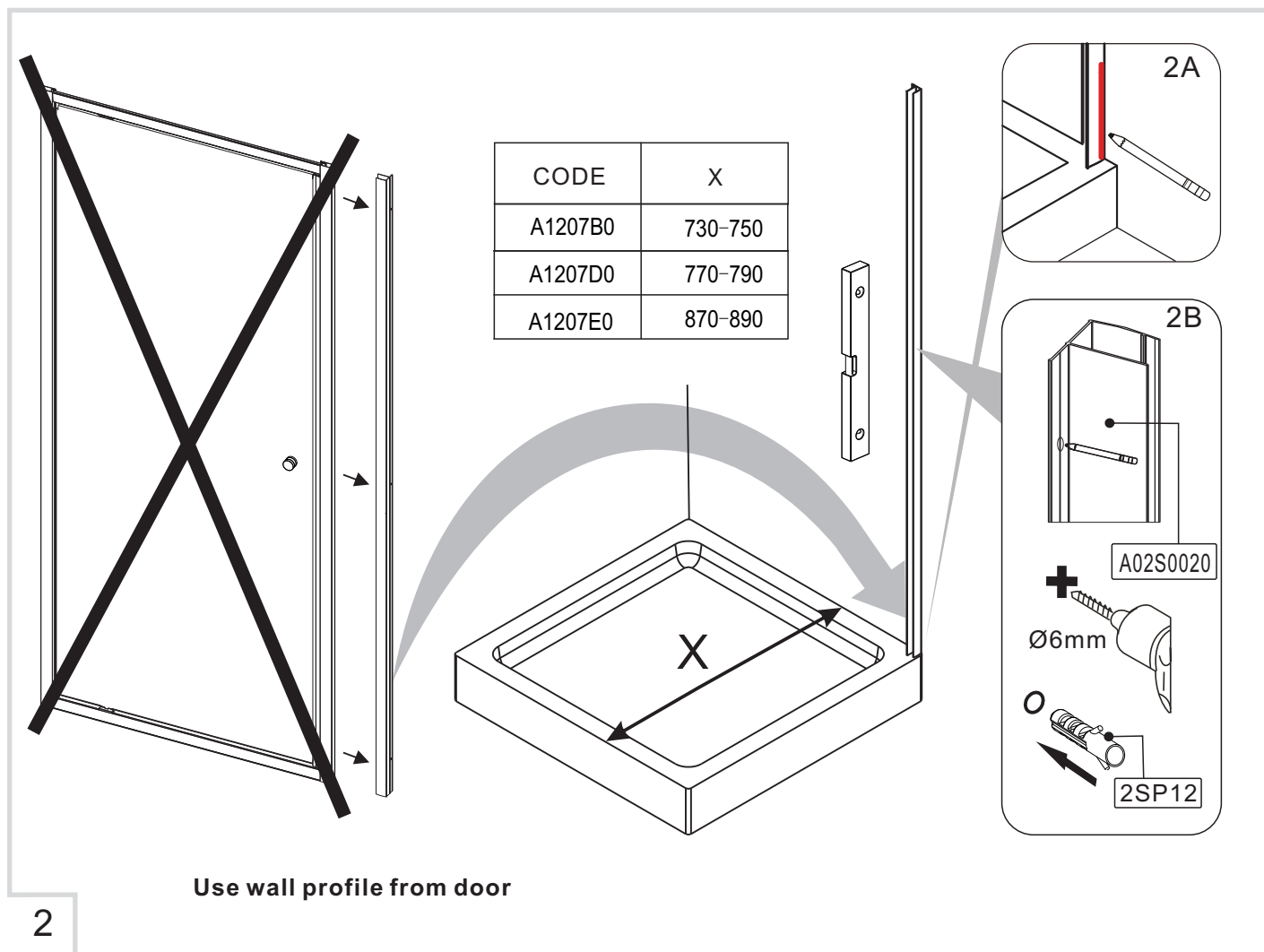

After your wall profiles have been fixed you can square your side panel on the tray and fix the wall profiles to the upright profiles as shown below.

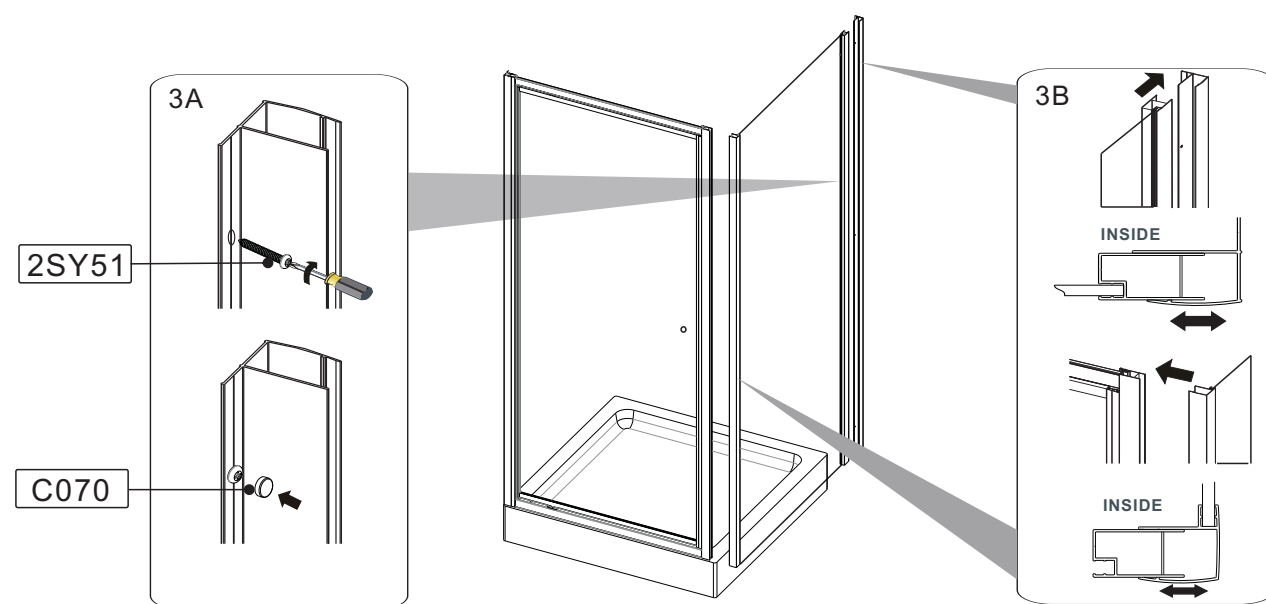

The same process is used to fix the corner post to the upright profile of the enclosure.

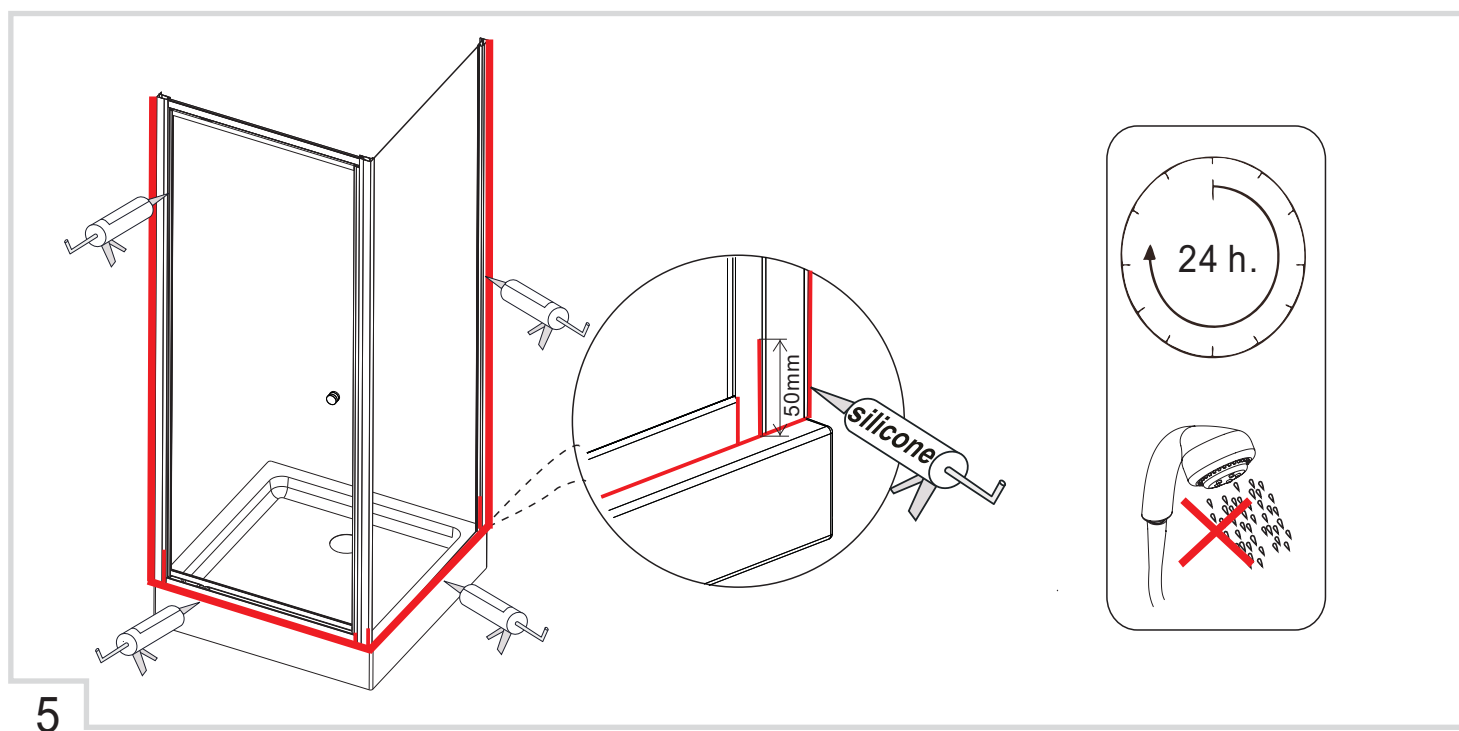
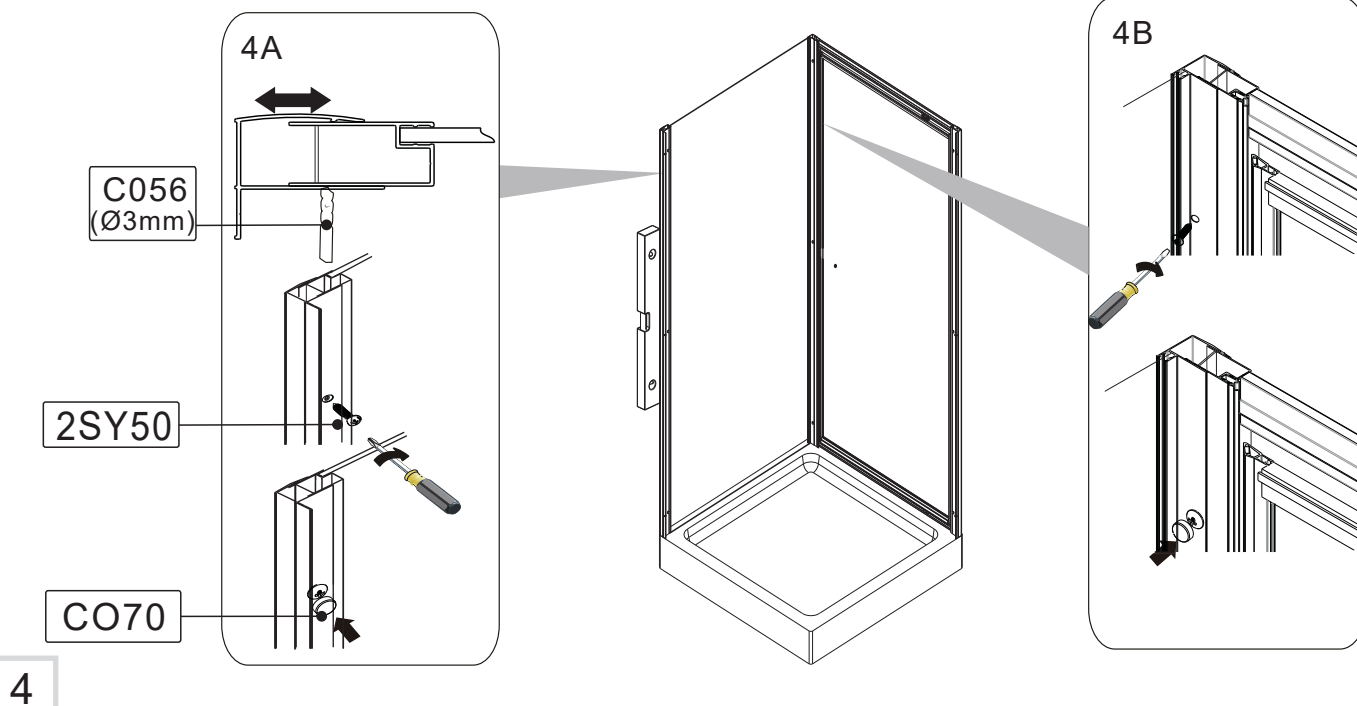

CE	
Merlyn Industries Ltd (MER09) Purcellsinn, Kilkenny, IRL.	
15	
EN 14428	
Shower enclosures with aluminium profiles and safety glass	
Cleanability	: Pass
Impact resistance/ shatter properties	: Pass
Durability	: Pass