

Geberit Duofix element for wall-hung WC, 112 cm, with Alpha concealed cistern 12 cm, 5.8 / 3 litres

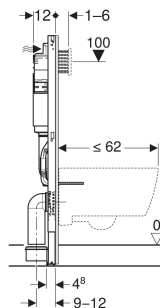
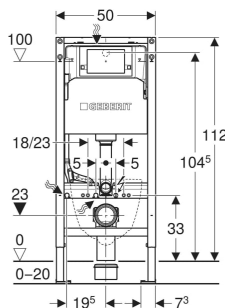

APPLICATION PURPOSES

- For metal and wood frame walls
- For installation in part- or room-height prewalls
- For installation in room-height partition walls
- For floor constructions 0–20 cm
- For wall-hung WCs

CHARACTERISTICS

- 2025 range
- Statically self-supporting frame, protected against corrosion with powder coating
- Frame for wall-hung WCs with connection dimensions as per EN 33 and projection up to 62 cm
- Alternative fastening point for wall anchors
- Foot plates made of plastic
- Foot plate depth suitable for installation in U-profiles UW 50
- Galvanised leg supports protected against corrosion
- Connection bend can be mounted without tools
- Geberit Alpha concealed cistern 12 cm fully insulated against condensation

- Cistern fulfils standard requirements in accordance with EN 14055, Class II
- For front actuation, suitable for dual flush
- Immediate post flush possible with factory setting
- Water supply connection on the rear or top centre
- Protection box for service opening, can be cut to length, protects against moisture and dirt
- With conduit pipe for feed pipe for Geberit AquaClean shower toilets and for connection cable
- Fastening option for electrical connection

TECHNICAL DATA

Flow pressure	0.1–10 bar
Operating temperature, water max.	25 °C
Flush volume, factory setting	5.8 / 3 l
Flush volume large, adjustment range	4 / 4.5 / 6 / 7.5 l
Flush volume small, adjustment range	2–4 l

Product material

Steel

SCOPE OF DELIVERY

- Water supply connection unit R 1/2", compatible with MasterFix and MeplaFix, with integrated angle stop valve and adapter ring
- Protection box for service opening
- 2 wall anchors
- 2 fixing brackets
- Connection set for WC, ø 90 mm
- Connection bend 90° made of PE-HD, ø 90 mm
- Adaptor socket made of PE-HD, ø 90 / 110 mm
- Fastening and protection material

ACCESSORIES

- Geberit Duofix fastening material for stud clearance 50–57.5 cm
- Geberit Duofix set of foot fastener on rear wall
- Geberit set of support brackets for WC ceramic appliances with small contact surfaces
- Geberit sound insulation set for wall-hung WC
- Geberit Duofix set of foot extensions 20 cm length



Art. no.	B cm	H cm	T cm	
458.039.00.2 New	50	112	12	

New article available from 01.05.2025



