

## BATHROOM FURNITURE SUBWAY 3.0

### PRODUCT INFORMATION

#### 1 . POSITION



Article number	C58400VE
Article title	Villeroy & Boch Subway 3.0 Vanity unit, 1 door, 351 x 429 x 309 mm, Brilliant White
Product designation	Vanity unit
Collection	Subway 3.0
Assembly / Assembly type	wall-mounted
Type of opening	1 door
Door hinge	hinges on right
Equipment	1 x door
Scope of delivery	1 x vanity unit , 1 x fastening set
Position of washbasin	washbasin on the middle, washbasin on right
Ordering information	Please order specified washbasin separately. It is not always possible to cancel or alter orders!
Depth in mm	309
Width in mm	351
Height in mm	429
Depth with handle mm	309
Depth without handle mm	293
Weight in kg	8,45
express delivery	Yes
Suitable for	selected handwashbasins
Function	with SoftClosing
Material front	Chipboard
Surface of front	Paint
Material body	Chipboard
Surface of body	Paint
Other material	Handle: aluminium
Other surfaces	Handle: glossy
Type of handles	Handle
EAN number	4062373841297

## COLOUR

### COLOUR DESIGNATION



Brilliant White

## TECHNICAL DRAWINGS

### C58400VE

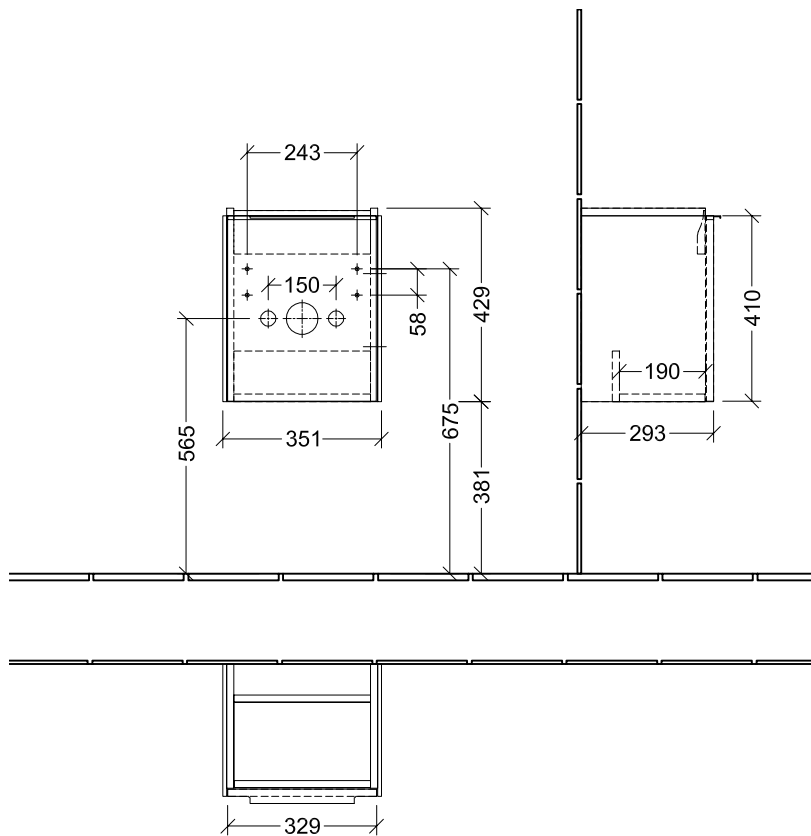

Subway 3.0  
C5840

V01 / 08.12.2020



**Villeroy & Boch**  
1748

## WASHBASINS SUBWAY 3.0

### PRODUCT INFORMATION

#### 1 . POSITION



<b>Article number</b>	<b>43703701</b>
Article title	Villeroy & Boch Subway 3.0 Handwashbasin, 370 x 305 x 130 mm, White Alpin, with overflow
Product designation	Handwashbasin
Collection	Subway 3.0
Assembly / Assembly type	wall-mounted
Scope of delivery	1 x handwashbasin
Ordering information	Optionally available: Outlet valve with ceramic cover.
Length in mm	305
Width in mm	370
Height in mm	130
Interior depth	85
Weight in kg	7,30
Number of tap holes punched through	1
Position of drill hole	central tap hole punched out
express delivery	No
Suitable for	1-hole mixer, Matching Villeroy&Boch furniture
Material	Sanitary ceramics
Surface	glossy
Colour name	White Alpin
With TitanGlaze	No
With overflow	Yes
EAN number	4062373850596

### COLOUR

#### COLOUR DESIGNATION



White Alpin

# TECHNICAL DRAWINGS

43703701

