

RECESSED CABINET INSTALLATION INSTRUCTIONS

IMPORTANT - PLEASE READ

Please read these instructions carefully before starting installation and keep for future reference. Remove all packaging and check the product for missing parts or damage before starting installation; we cannot accept any liability for deficit / refit costs where a damaged or faulty product has been fitted. In addition we do not accept responsibility for any problems that arise through incorrect installation or modification of the product.

Due to our commitment to continuous product development we reserve the right to alter specifications without notice. Products are guaranteed against manufacturing defects for the first purchaser only and the guarantee is non-transferable. Our liability under any guarantee expressed or implied is strictly limited to replacement of defective goods or a refund at our discretion and no consequential losses will be entertained. Proof of purchase will be required.

General Installation

This product should only be installed by a suitably qualified installer.

Ensure the domestic electrical mains supply to which the cabinet is to be connected is turned off prior to installation

When drilling or fixing into walls or floor it is essential that you check for pipes or wires before commencing. These instructions are based on installation to a blockwork wall; if you are installing on to plasterboard / stud walling please use the appropriate fixings and ensure that the wall is able to fully support the weight of the product.

Product Care

Our products are finished to the highest standard and due care needs to be taken to ensure their looks are retained. We recommend cleaning all products with a soft damp cloth ONLY and advise strongly against the use of ALL cleaning products i.e. powders and liquids. If the above instructions are not followed this will invalidate your guarantee in the event of a problem occurring.

Installation

This furniture has been designed to be recessed within a void wall. It is very important that the correct opening size is achieved so that the cabinet fits correctly.

A metal frame is available that can be installed during the building of your void wall to help create an exact size opening for the cabinet – please contact your dealer for more information.

Alternatively, please ensure that you have an opening size of 749 x 486mm plus a minimum depth of 200mm from the tile face to the rear of the void wall.

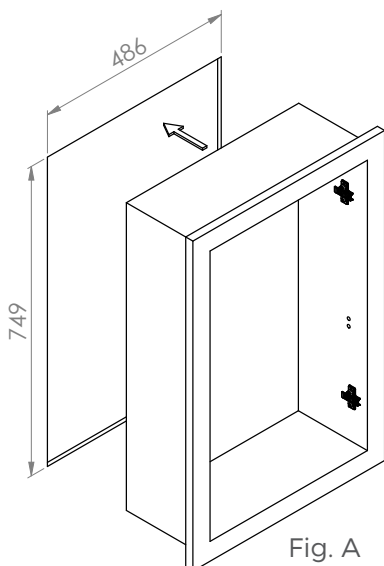

Minimum depth 200mm
from tile face to rear of void

FITTING

1. Ensure the electrical connection to the door is disconnected and release the door by gently pulling the catch on the hinge towards you to release the hinge unit (See Fig. B).

NOTE: You do not need to unscrew the hinges from the door or cabinet.

2. Connect the domestic mains supply according and manoeuvre the cabinet into the wall aperture (Fig. A)

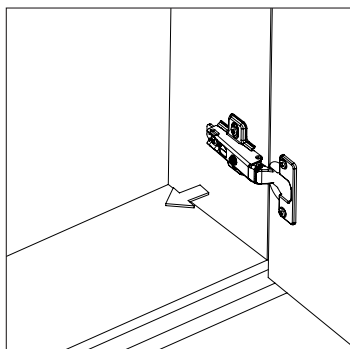

Fig. B

3. Secure the cabinet into the wall aperture with the supplied screws, via the two holes (two on each side)

4. Insert the supplied shelf brackets into the appropriate holes on the inside of the cabinet, depending on what height each shelf is required. Slide each shelf into position and secure in place by tightening the small plastic grub screw on the underside of each shelf bracket.

5. Offer the door up to the cabinet and carefully connect the wires using the connection blocks - take care to connect the blocks in the correct orientation, so that the red wire connects to the red wire and black to black. Once connected, carefully slide any excess wiring and the connector blocks inside the carcass and reconnect the hinges. Hinges are reconnected by clipping the front of the hinge in and then applying pressure on the back of the hinge until an audible 'click' is heard.

6. If necessary, hinges can be adjusted to reposition the door(s) see below

7. Switch on the mains supply

ADJUSTMENTS

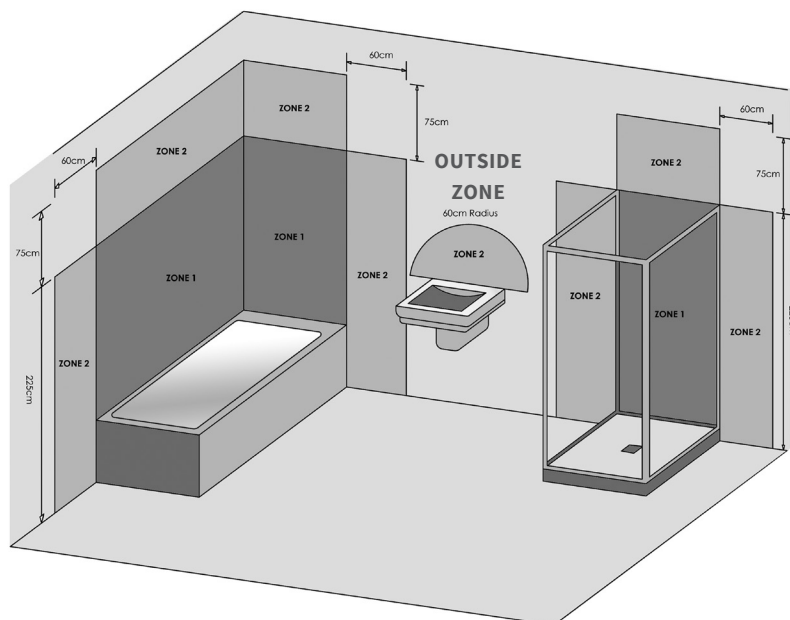
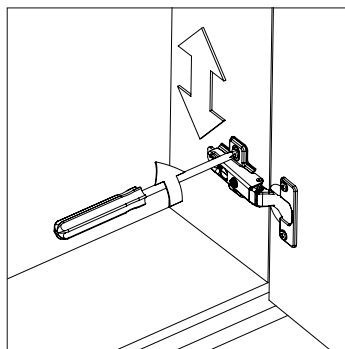
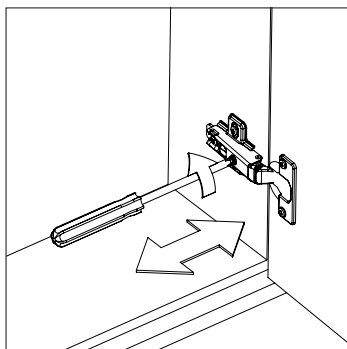
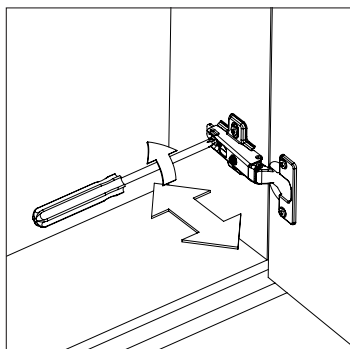

**THIS PRODUCT IS SUITABLE FOR INSTALLATION
IN ZONES: 2 & OUTSIDE ZONE**