

PRODUCT DATA SHEET

Burlington®

PRODUCT CODE
FC1BM

RANGE
Furniture

DESCRIPTION
Door Unit & 2 Round Corner Units Matt Black



CATEGORY	Furniture
WARRANTY DETAILS	10 Years
COLOUR	Matt Black
FINISH APPLICATION	Lacquered
PRIMARY MATERIAL	MDF
INSTALL TYPE	Floor Standing
PRODUCT WIDTH MM	1336
PRODUCT HEIGHT MM	820
PRODUCT DEPTH MM	548
PRODUCT NET WEIGHT KG	74

DRAWER BOX	MDF
DRAWER RUNNERS	Soft Close Hinge
DRAWER ADJUSTMENT	2 way adjustment
WALL HANGERS	Yes
ADJUSTABLE FEET	Yes
DRAWER CAPACITY	15kgs

TECHNICAL DIMENSIONS

Dimensions in mm unless otherwise specified.

Tolerances (per material type) apply.

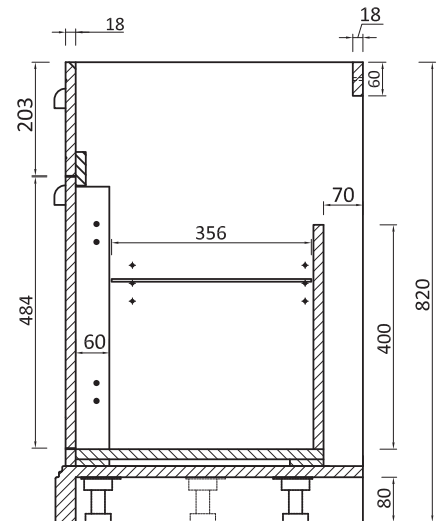
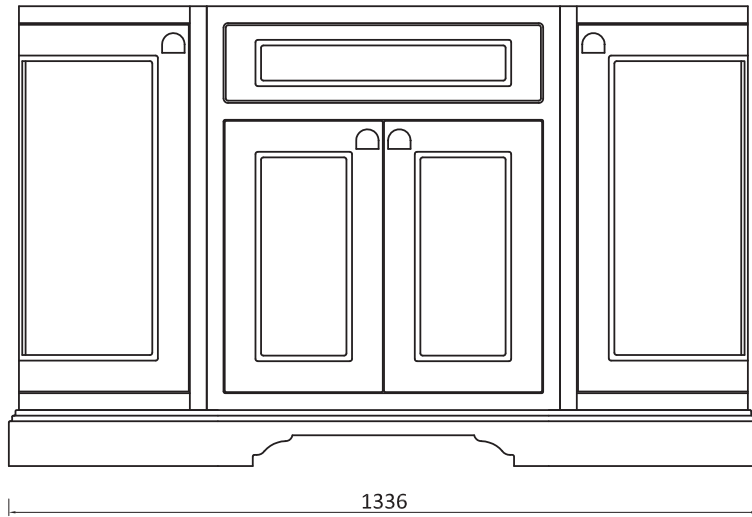
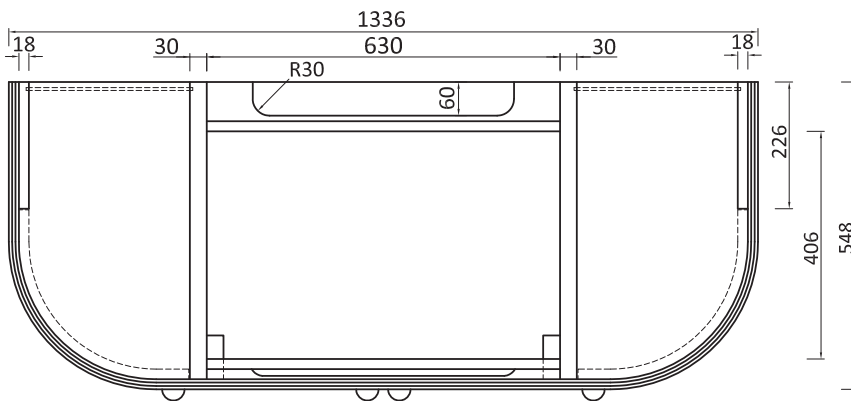

SPARES LIST

Only the parts labelled are available as spares.

SPARES AVAILABLE UPON REQUEST