

PRODUCT DATA SHEET

Burlington®

PRODUCT CODE
GU8500DVW_FS

RANGE
Guild

DESCRIPTION
Guild Floor Standing Vanity 850mm
Varley White c/w handles



| | |
|-----------------------|----------------|
| CATEGORY | Furniture |
| WARRANTY DETAILS | 10 Years |
| COLOUR | Varley White |
| FINISH APPLICATION | Lacquered |
| PRIMARY MATERIAL | MDF |
| INSTALL TYPE | Floor Standing |
| PRODUCT WIDTH MM | 780 |
| PRODUCT HEIGHT MM | 770 |
| PRODUCT DEPTH MM | 522 |
| PRODUCT NET WEIGHT KG | 31.5 |
| STANDARDS | EN14749:2016 |

| | |
|-------------------|------------------|
| DRAWER BOX | MDF |
| DRAWER RUNNERS | DTC / SS10C350H1 |
| DRAWER EXTENSION | Full extension |
| DRAWER ADJUSTMENT | 2 way adjustment |
| WALL HANGERS | No |
| ADJUSTABLE FEET | Yes |
| DRAWER CAPACITY | 15 kgs |
| DRAWER OPERATION | Soft close |

TECHNICAL DIMENSIONS

Dimensions in mm unless otherwise specified.

Tolerances (per material type) apply.

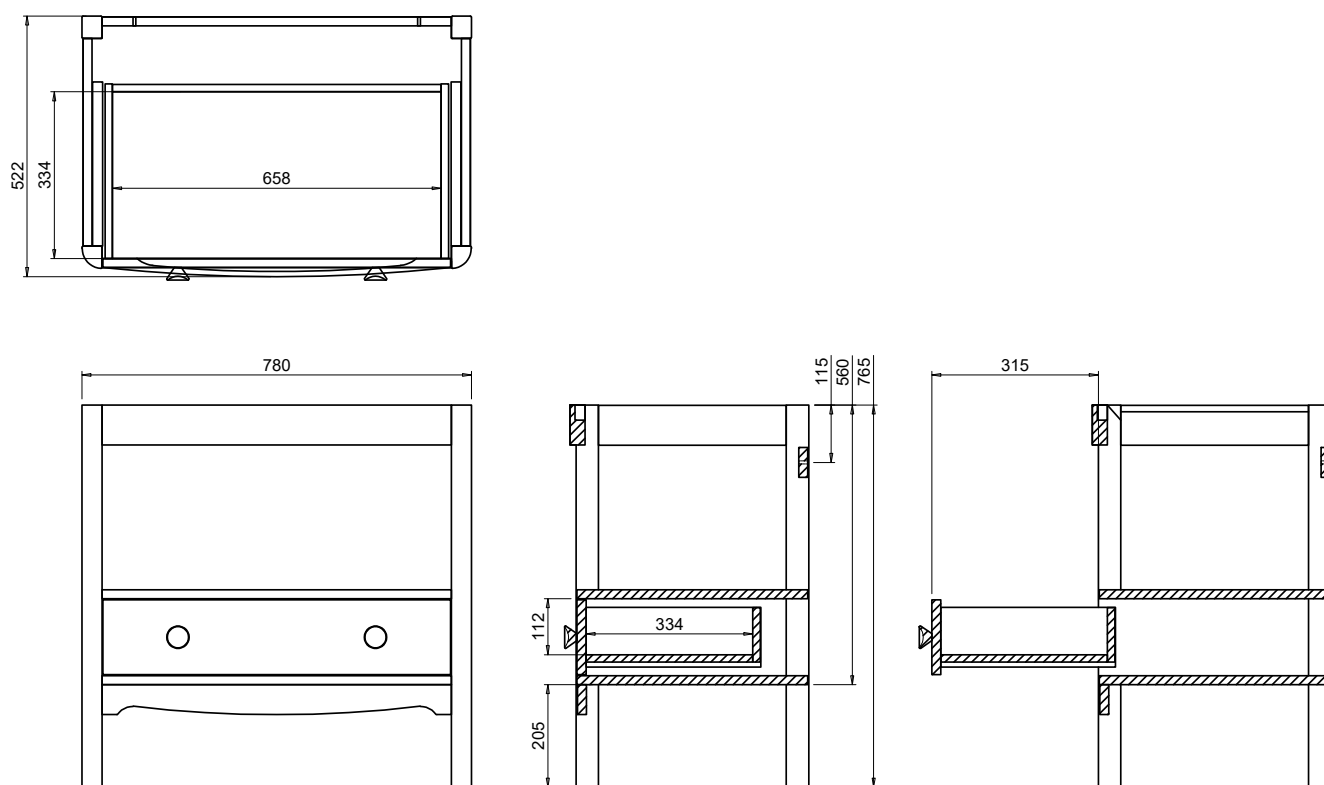

SPARES LIST

Only the parts labelled are available as spares.

SPARES AVAILABLE UPON REQUEST

PRODUCT DATA SHEET



PRODUCT CODE
GU850TMQ

RANGE
Guild

DESCRIPTION
Guild Vanity Top 850 with Upstand
Marquina



| | |
|-----------------------|--------------------------|
| CATEGORY | Furniture |
| WARRANTY DETAILS | 10 Years |
| COLOUR | Marquina |
| PRIMARY MATERIAL | Solid Surface |
| SECONDARY MATERIAL | Solid Surface |
| INSTALL TYPE | Furniture Mounted |
| PRODUCT WIDTH MM | 812 |
| PRODUCT HEIGHT MM | 20 |
| PRODUCT DEPTH MM | 531 |
| PRODUCT NET WEIGHT KG | 27 |
| STANDARDS | BS EN 14749:2016+A1:2022 |

| | |
|-----------------|----|
| DRAWER BOX | No |
| WALL HANGERS | No |
| ADJUSTABLE FEET | No |

TECHNICAL DIMENSIONS

Dimensions in mm unless otherwise specified.

Tolerances (per material type) apply.

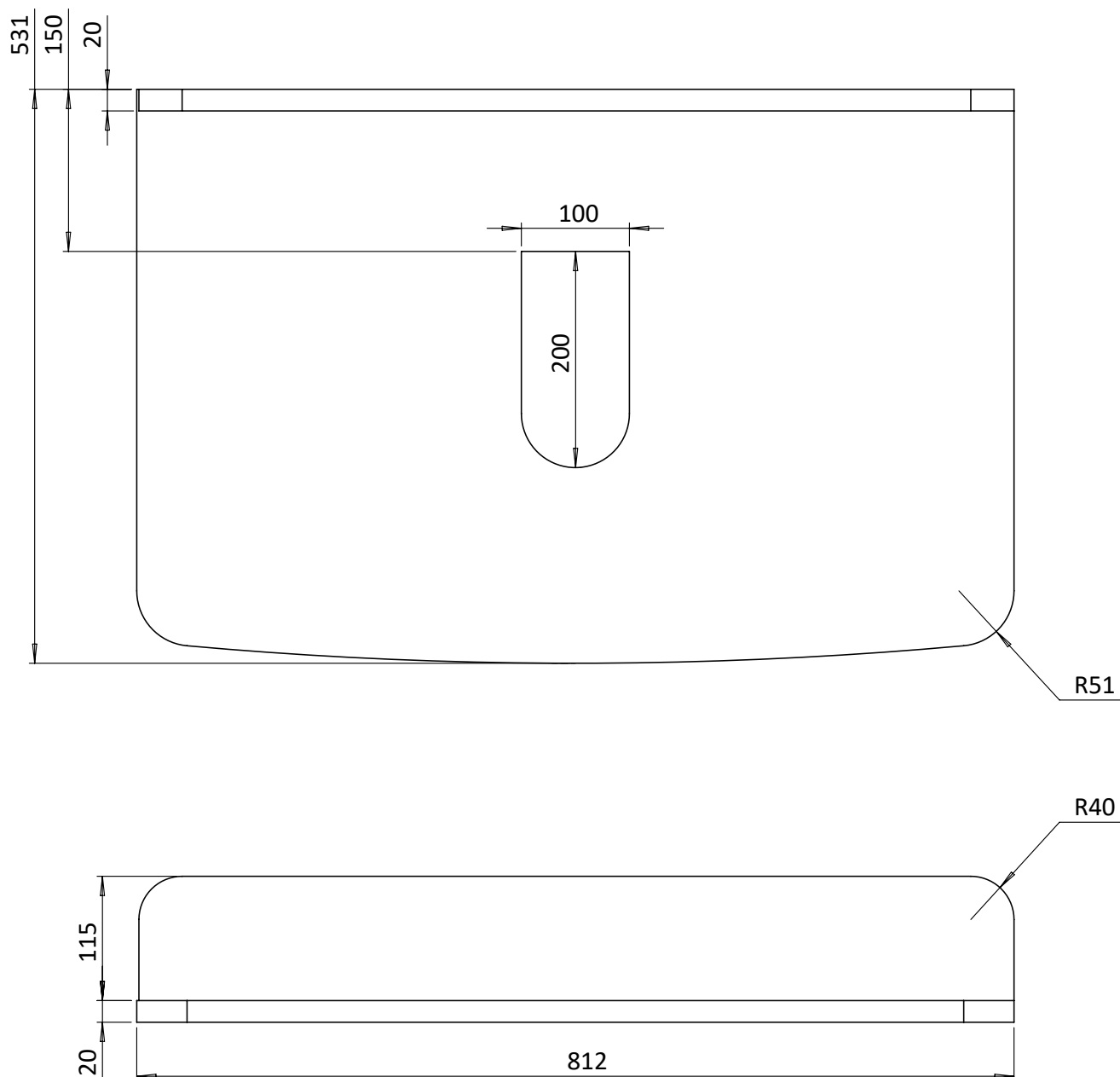

SPARES LIST

Only the parts labelled are available as spares.

SPARES AVAILABLE UPON REQUEST