

crosswater[✕]

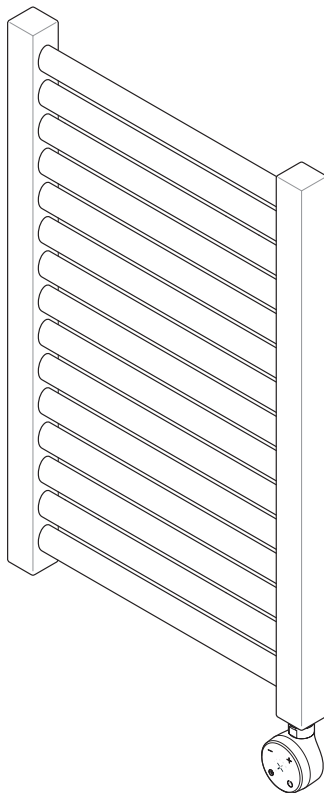

User Manual

All Electric Bathroom Towel rail

FEATURES AND FUNCTIONS

- 5-step heating temperature range
- Low energy consumption in stand-by mode
- Low energy consumption in stand-by mode
- Temperature sensor installed in the heating element
- Double overheating protection
- Heating element protection against dry functioning
- ANTIFREEZE function, protection against temperatures below 5-7°C
- 2h drying function with a switch-off mode
- Turn off time

The element is the I class heating element.

FUNCTIONALITY

The element offers 5 temperature settings ranging from 30°C to 60°C. It is equipped with an electronic temperature sensor that guarantees precise temperature control. The element displays the currently set temperature level and the status of the heating cycle using an LED indicator. The heating element has a very low power consumption in a standby mode.

SAFETY

The element is equipped with 'frost' protection (ANTIFREEZE). It also has a double protection against overheating of the radiator and displays a warning in case of malfunction. It has an active safety feature in case of operation in a dry radiator.

DRYER FUNCTION

This function allows the setting of a higher heating power for two hours, after which the device returns to the previous state.

INTELLIGENT BUILDING SYSTEMS

In the event of a power failure the MOA remembers its previous settings therefore making it suitable for connection to external timers and intelligent building systems.

Installation Guide & User Manual

Our products have been designed and manufactured in such a way to ensure that all quality, functionality and aesthetic requirements are met. We would like to congratulate you on the purchase of this great product and wish you a pleasant experience with it.

Please read these instructions carefully before starting installation and keep in a safe place for future reference. ENSURE the room is well heated and ventilated.

Before installation, carefully check the contents of the package and the instructions contained in the manual included with the installation kit. Cross-water will not be held responsible for any de-fit / re-fit costs where faulty product has been fitted.

If any fault is found with materials or workmanship, it must be reported immediately to the manufacturer. Remedial action will be taken, based on information received, on condition that:

1. Full details are supplied to the manufacturer.
2. The product has not been modified or tampered with;
3. The manufacturer is informed of any damage/shortages prior to installation.
4. The product has not been installed, or attempts have been made to

install.

Only the installation fittings supplied with the product can be used.

We do not accept responsibility for any problems that may occur through incorrect installation.

The device should only be installed by a fully qualified installer such as NICEIC, IET - failure to comply to this will invalidate all warranties.

This product **MUST** be installed in accordance with the the latest requirements of Part P of the Building Regulations. Failure to comply will invalidate any warranty.

Electric radiator

Guide to safe installation and use.

1. This product **MUST NOT** be installed with an extension lead, 3 pin plug or electric plug adapters.
2. The device is not equipped with an external temperature controller.

Do not use the device in a small room if unsupervised disabled or incapacitated individuals are inside it. Only use the device if those individuals are under constant supervision.

3. Electric heater is not a toy. Children under the age of 3 should not be allowed within close proximity of the device without the supervision of an adult.

Children aged 3 to 8 should only be allowed to operate the heater when it has been properly installed and connected. The child must be under adult supervision or have been trained to safely operate the device while understanding the risks. To ensure the safety of very small children, install the electric dryer so that the lowest tube is at least 600 mm above the floor.

4. Note: Some parts of the radiator can be hot and can cause injury. Pay special attention to the presence of children or people with disabilities.

5. If the device is used as a clothes and towel dryer, ensure that the fabrics drying on it have only been washed in water with standard washing products, avoiding contact with any harsh chemicals.
6. While connecting the radiator to electric installation ensure that the circuit has a 30 mA residual-current circuit breaker and an appropriate over-current circuit breaker. With the permanent installation (cable connection without plug) it is also mandatory to provide an omnipolar cut-off switch with a minimum contact opening of 3 mm for disconnecting the device on all poles.
7. The device version labelled PB can be installed in bathrooms in zone 1, as defined by applicable law, subject to any additional regulations concerning electrical installations in wet areas.

Other versions of the device can be installed in Zone 2 or beyond. In any case, if the radiator body does not have above-standard corrosion protection, the distance from the radiator to the water intake should be min. 1 m.

8. The device is recommended solely for home use, as described in the manual.
9. Ensure that the heater has been installed on a wall in accordance with its installation manual.
10. Please forward this instruction manual to the end user.

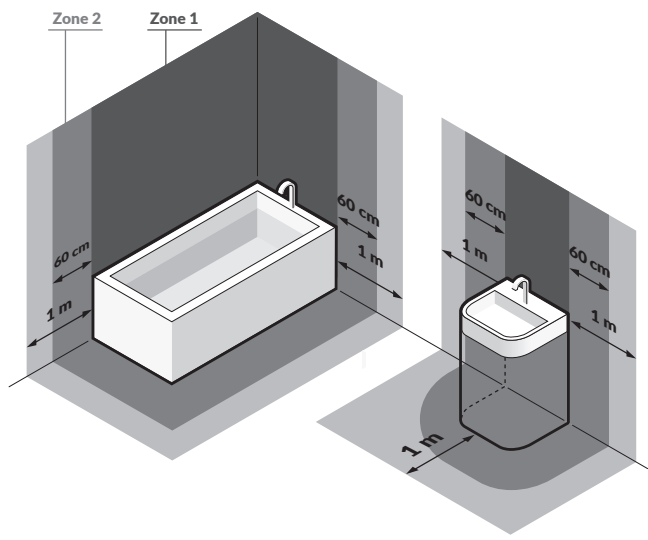
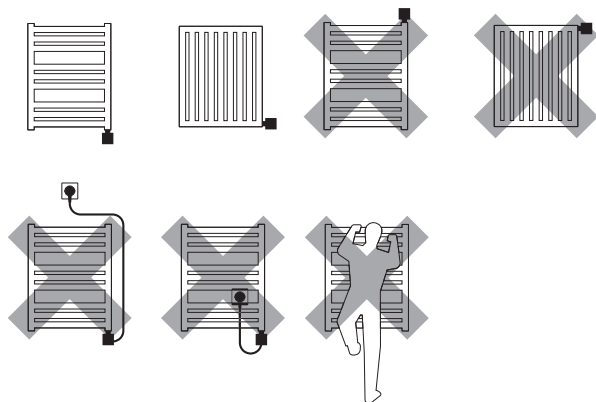

1. Fitting and connection of the heating element should only be performed by a qualified installer. The device should only be installed by a fully qualified installer such as NICEIC, IET - failure to comply to this will invalidate all warranties.
2. Connect the unit to a sound electrical installation (see the ratings on the heater).
3. Ensure that the power cord does not touch the hot parts of the heating element or radiator.
4. Before installing or removing the device, make sure it is disconnected from the power source.
5. Do not open the device — any interference with internal components will invalidate the warranty.
6. Fitting and Installation of the device must be carried out in accordance with all local regulations for electrical safety, including installation within permissible locations only. Observe bathroom electrical zone regulations. This product **MUST** be installed in accordance with the the latest requirements of Part P of the Building Regulations. Failure to comply will invalidate any warranty.

Safety requirements — use

1. Regularly check the device for damage to ensure it is safe to use.
2. If the power cord is damaged the device should not be used. Unplug the device and contact the manufacturer or distributor.
3. Do not allow flooding into the heating element casing.
4. The heating element and radiator can heat up to high temperatures. Please be cautious — avoid direct contact with the hot parts of the equipment.
5. The device must be disconnected from the mains during cleaning and maintenance.
6. Cleaning of the equipment by children under 8 years of age is only permitted under appropriate supervision.

Intended use of device

The electric radiator has been designed as a dryer for towels and clothes with a load not exceeding 5 kg.

Technical information

Model markings (power cable type):	PB (Straight cable without plug). Device intended to be connected permanently to the system. Protection required: 30 mA residual-current circuit breaker and an omnipolar cut-off switch with a minimum contact opening of 3 mm for disconnecting the device on all poles.
Type of electrical connection:	Y
Power supply:	230 V / 50 Hz
Appliance class:	Class I
Towel rail connection thread:	G 1/2"
Ingress protection rating:	IPx5
Heat outputs available:	400W, 600W

The electric radiator fully complies with the following regulations of the European Parliament and of the Council and the standards that follow from them:

LOW VOLTAGE DIRECTIVE, 2014/35/EU

EN 60335-1:2012, EN 60335-2-73:2003+A1:2006+A2:2009, EN 60335-2-43:2002 + A1:2006+A2:2008

EMC DIRECTIVE, 2014/30/EU

EN 62233:2008, EN 55014-1:2017, EN 55014-2:2015, EN 61000-3-2:2014, EN 61000-3-3:2013

RoHS DIRECTIVE(2015/863/EU)

WEEE DIRECTIVE(2012/19/EU)

Before installation or first use:

1. Read the chapter Safety requirements — Installation.
2. To properly mount the radiator on the wall, follow the instructions in the manual included with the mounting kit.
3. Follow the subsequent guidelines when connecting the electrical installation:
 - a. Brown wire — live connection to the circuit (L).
 - b. Blue wire — connect to neutral (N)
 - c. Yellow & green wire — earth connection (PE).

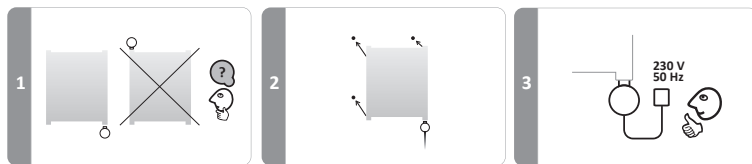

Notes prior to removal:

1. Before dismantling permanently, disconnect the heating element from the mains and ensure that the radiator is not hot.
2. Be aware. A radiator filled with liquid can be very heavy. When moving the radiator, ensure that you take the necessary safety precautions.

Product disposal





This product should not be disposed of as general waste but should be brought to the appropriate collection point for recycling of electric and electronic devices. This information is provided by the sign on the product,

user manual and packaging. Information on the appropriate point for used devices can be provided by your local authority, product distributor or the store from where the product was purchased. Thank you for your effort towards protecting the environment.

Maintenance

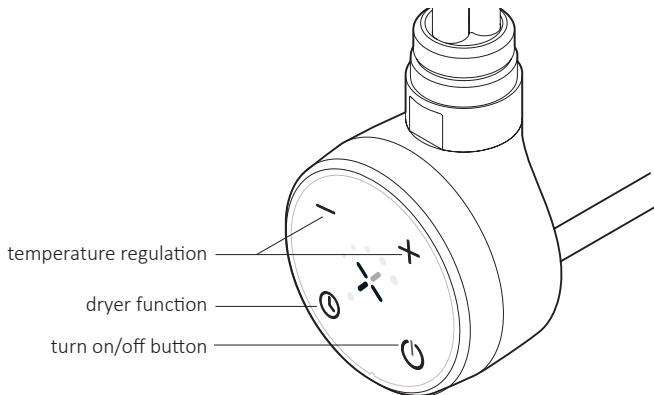
- Before performing maintenance, always isolate the unit from the main electrical supply system.
- Clean the product with a dry or damp cloth. If necessary, use a very small amount of detergent, ensuring that it contains no solvents or abrasives.



Turning the device on with the  button will result in the radiator heating up to the set temperature. After reaching the set temperature the device will turn off and on regularly in order to maintain the set temperature.

The construction of the device as well as the physical characteristics of the heating agent inside the radiator, influence the way in which the heat is distributed — the temperature of the bottom pipes on the radiator (especially the two located at the very bottom of the radiator), may be lower than the temperature of the remaining parts of the radiator — this is normal.

Temperature increase

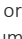
In order to increase the temperature of the radiator, press  once or several times as required; the correct number of diodes will start blinking. If the last active LED is flashing, it means that the temperature has not

yet been reached, if the last LED is constantly lit, the set temperature has been reached. During the operation of the device, as the temperature rises, fewer and fewer LEDs flash, and more and more lights up constantly, until the set temperature is reached.

Temperature decrease

In order to decrease the temperature of the radiator, press  once or several times as required; the correct number of diodes will start blinking. The number of permanently lit LEDs indicates the set temperature, and the last flashing LED indicates the current temperature. The next LEDs will go out as the temperature decreases.

Anti-freeze function

When the device is off and the temperature surrounding the temperature sensor drops

to below 6°C, the device will switch on automatically. This is to prevent the heating agent inside the radiator from freezing. The activation of Anti-freeze mode is indicated by the blinking of the middle diode.

Dryer function

The Dryer turns the device on for 2 hours, e.g. in order to dry a towel. After this period of time the device automatically switches to the last mode set before the dryer mode was activated.

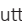
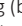
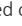
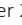
Dryer function can be activated during heater operation by pressing  button. You can now freely adjust desired temperature level (buttons  and ). After 2 hrs heater will revert to the previous setting (before dryer function activation). To use 2 hrs timer heating element must be switched off. Switch it on by pressing  button. After 2 hrs heater will switch off automatically.

Press  button at any time to interrupt the dryer mode.

Calibrating the temperature span

The standard temperature span of the heating element is 30-60°C. It is possible to increase or decrease that span by setting a maximum temperature of between 45°C and 65°C, (minimum temperature of 30°C stays unchanged). This allows the user to

achieve a maximum temperature which is higher than the standard or to effectively heat a space with the device during lower surrounding temperatures.

Example: for the temperature regulation span of up to 45°C (30-45°C) modification by one step (one diode), means increase/decrease of temperature by 3.75°C, while for the temperature regulation span of up to 65°C (30-65°C) modification by one step means increase/decrease by 8.75°C.

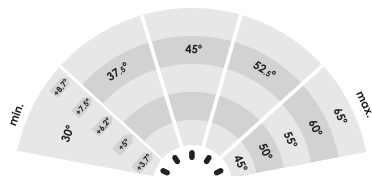

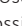
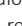
In order to modify the temperature span, unplug the device and plug it back in, while pressing  button. A single diode will start blinking on the display panel. Use  and  buttons to set one of the 5 possible maximum temperatures. The first diode stands for 45°C. The following diodes refer to the following maximum temperatures: 50°C, 55°C, 60°C and 65°C.

After selecting the new temperature span press on/off button to store the new settings.

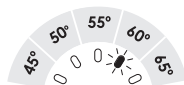

Problem solving

Problem	Possible cause	Solution
The device is plugged in, no diodes are on.	Problem with the mains electrical connection.	Check the mains electrical supply is working and fuse/RBC is working correctly.
Heating element is not heating, outside diodes are blinking alternately.	Temperature sensor has been damaged.	Disconnect the device completely, wait until the radiator cools down and re-connect it again.
The device is heating despite turning it off with the  button.	Damaged electronics.	Disconnect the device completely, wait until the radiator cools down and re-connect it.
If the problem continues please contact your installer.		

For any further information please contact us on: **0345 873 8840**

Or visit our web-site at: **www.crosswater.co.uk**

The manufacturer reserves the right to make technical modifications without prior notice.

Crosswater Limited

Lake View House, Rennie Drive,
Dartford, Kent DA1 5FU
Tel: +44 345 873 8840
technical@crosswater.co.uk

20210325 CIBTO MPGKE-431



Register your Guarantee

Thank you for purchasing your new product.
Enjoy your Guarantee by registering it today.

Visit bathroombrands.com/guarantee to register
your product and see terms & conditions.

crosswater[®]

Burlington[®]

CLEARWATER[®]

BRITTON[®]

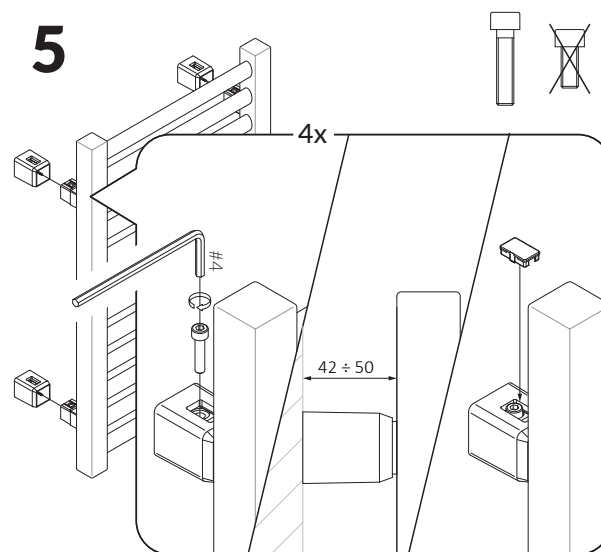

crosswater^x

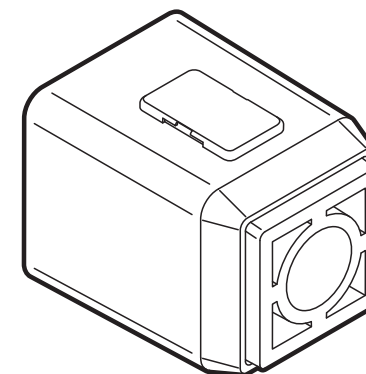

6 a/b/c*

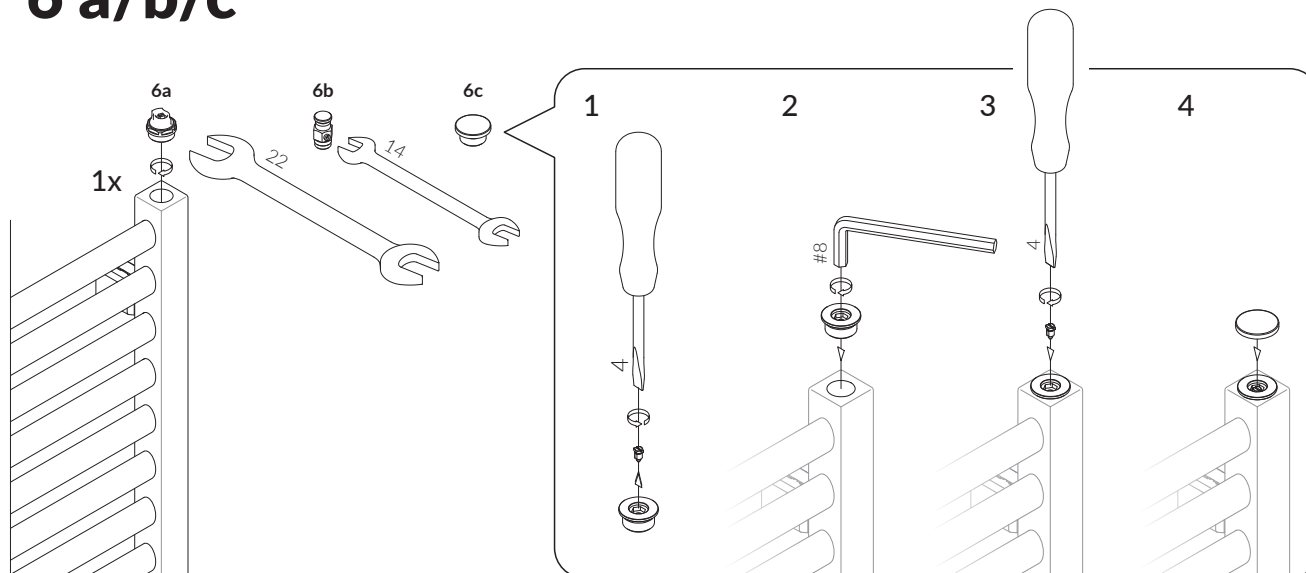

User Manual

Mounting bracket MKP/MKS

 $4x$

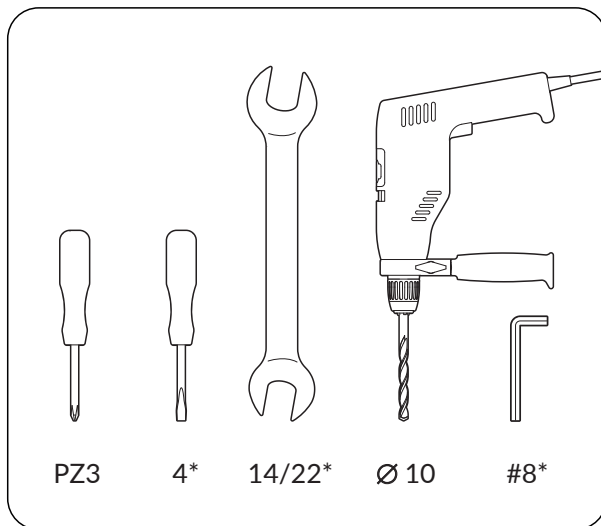
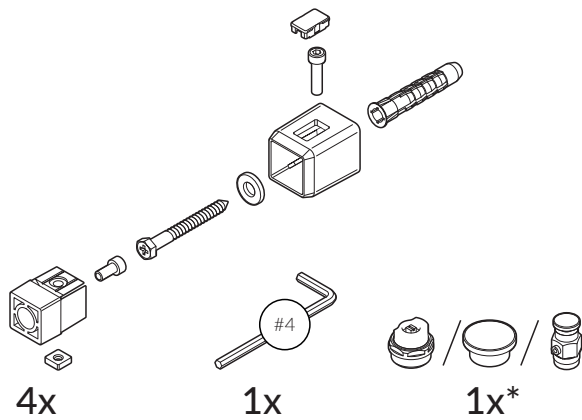

*Refers to water and dual fuel version.

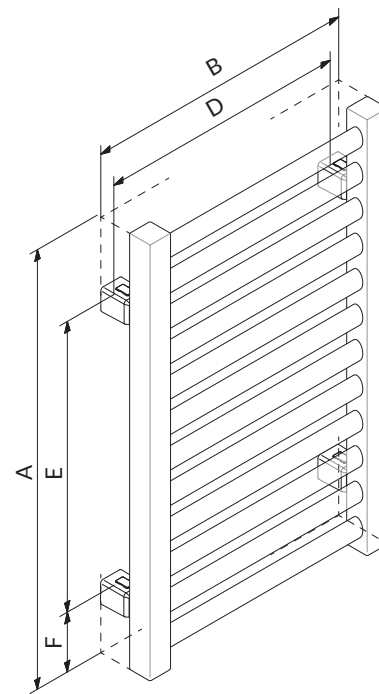

2

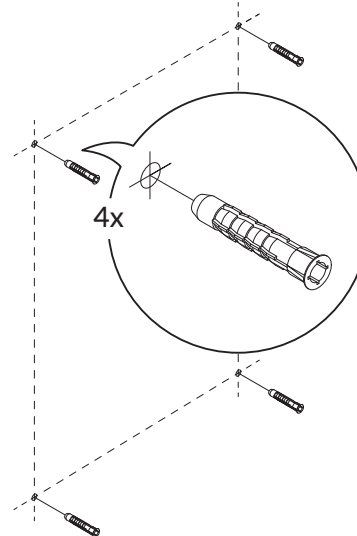

1

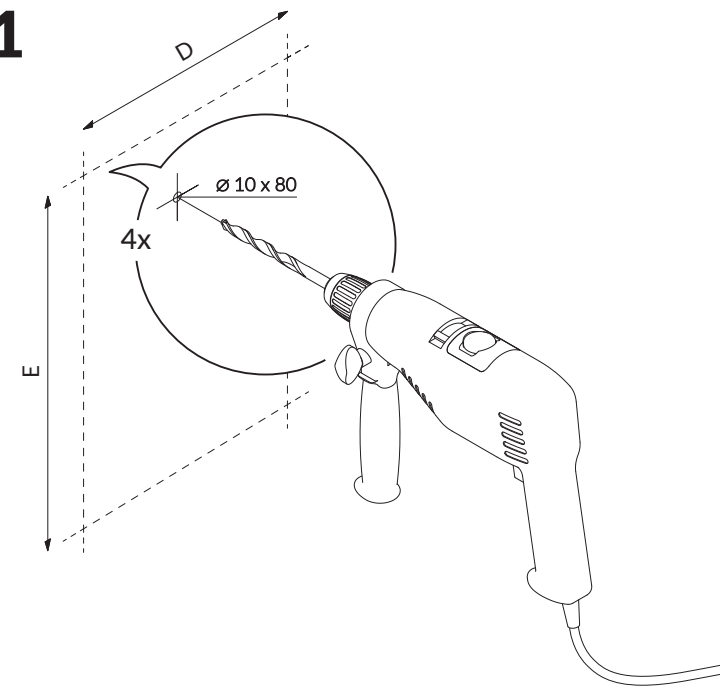

3

