

B A Y S W A T E R

London W.2

CODE: BAYR017

DESCRIPTION: Nelson Triple Radiator 1500X381

CATEGORY: Heating

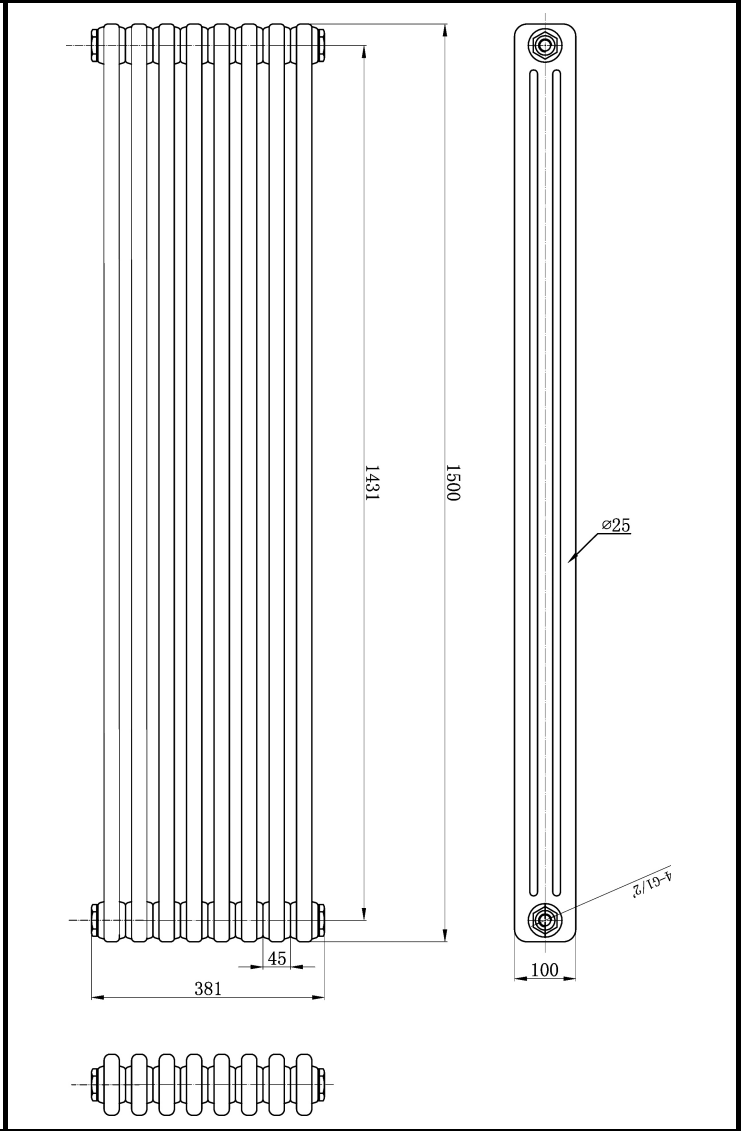
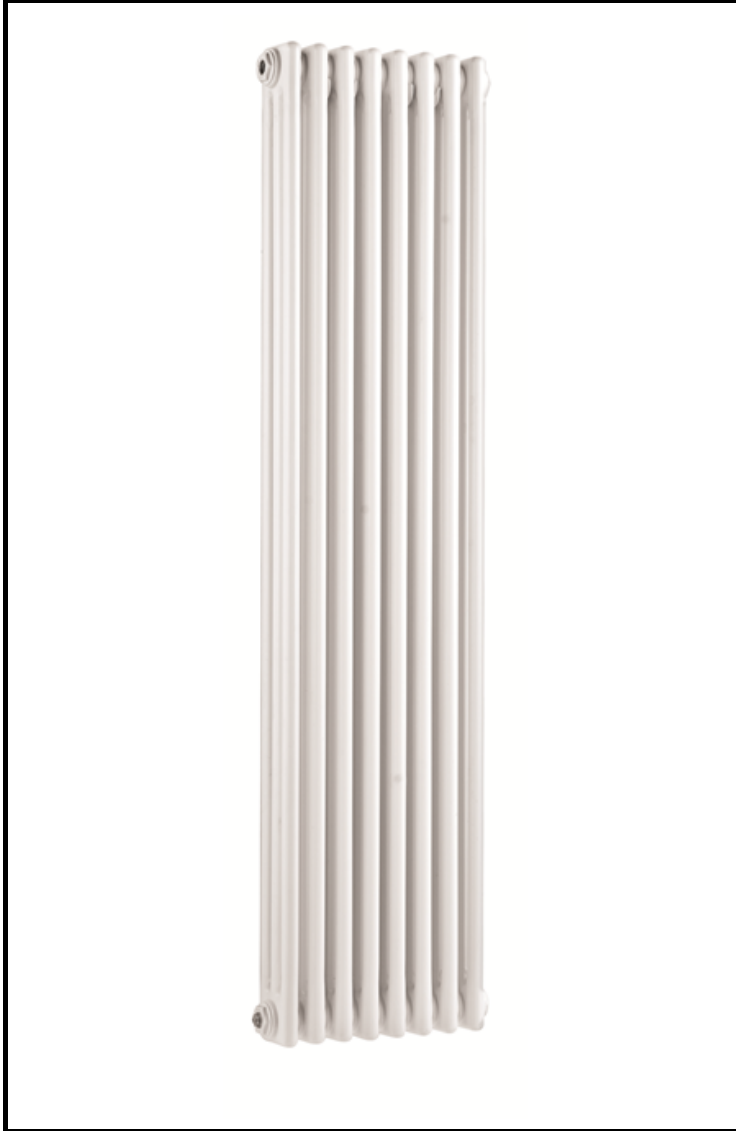

PRODUCT DIMENSIONS				
Height (mm)	Width (mm)	Depth (mm)	Length (mm)	Nett Wgt Kg
1500	381	100		26.7

PACKAGING DIMENSIONS			
Height (mm)	Width (mm)	Length (mm)	Gross Wgt Kg
1600	350	157	26.7

PACKAGING DATA			
Box Colour	White Cardboard Shrinkwrapped		
Box Qty	1	Label Colour	White Label
Label Size	100 x 50	Label Qty	2

OUTER BOX DIMENSIONS (If Applicable)			
Height (mm)	Width (mm)	Length (mm)	Gross Wgt Kg
Barcode	5055275890066		

PRODUCT DETAILS						
Contry of Origin	United Kingdom					
Fitting Instruction	Yes					
RAL No	9016					
Heat Element Wattage	Not Applicable					
BTU Outputs	30°C	1959	50°C	3863	60°C	4924
Pipe Centres	471mm					
Packaging Volume (L)	97					
Wall to Ctr of Tappings	75					
Dual Fuel	N/A					

Certification	CE	No	RoHS	N/A	WEEE	N/A
Colour/Finish	White					
Product Material	Steel					
Heat Element Wattage Compatible	N/A					
Thermal Outputs (Watts)	30°C	574	50°C	1132	60°C	1443
Max Projection	140mm					
Tube Diameter	25mm					
Floor to Ctr of Tappings	N/A					

B A Y S W A T E R

London W.2

CODE: BAYR999

DESCRIPTION: Nelson Floor Mounting Kit

CATEGORY: Heating

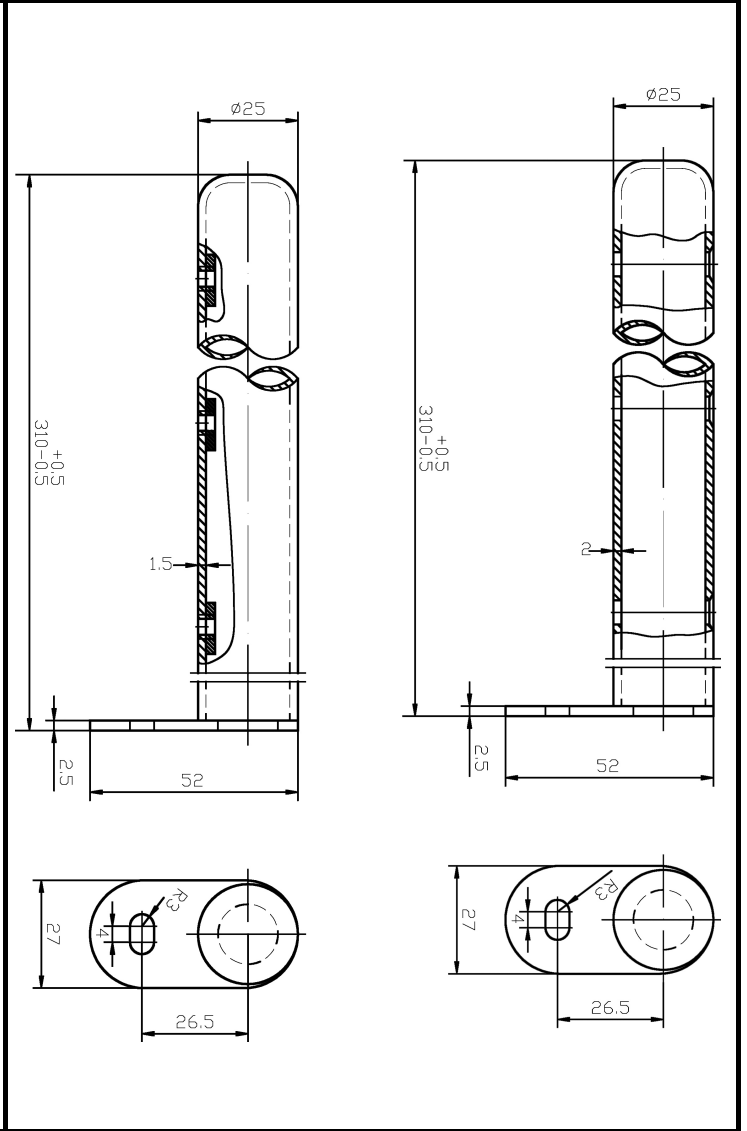

PRODUCT DIMENSIONS				
Height (mm)	Width (mm)	Depth (mm)	Length (mm)	Nett Wgt Kg
310	27	52		38

PACKAGING DIMENSIONS			
Height (mm)	Width (mm)	Length (mm)	Gross Wgt Kg
1100	675	157	38

PACKAGING DATA			
Box Colour	White Cardboard Box		
Box Qty	1	Label Colour	White Label
Label Size	100 x 50	Label Qty	1

OUTER BOX DIMENSIONS (If Applicable)			
Height (mm)	Width (mm)	Length (mm)	Gross Wgt Kg
Barcode	5055275890141		

PRODUCT DETAILS					
Contry of Origin	United Kingdom				
Fitting Instruction	No				
RAL No	9016				
Heat Element Wattage	Not Applicable				
BTU Outputs	30°C	N/A	50°C	N/A	60°C
Pipe Centres	N/A				
Packaging Volume (L)	N/A				
Wall to Ctr of Tappings	N/A				
Dual Fuel	N/A				

Certification	CE	N/A	RoHS	N/A	WEEE	N/A
Colour/Finish	White					
Product Material	Steel					
Heat Element Wattage Compatible	N/A					
Thermal Outputs (Watts)	30°C	N/A	50°C	N/A	60°C	
Max Projection	N/A					
Tube Diameter	N/A					
Floor to Ctr of Tappings	N/A					