

Geberit low-height concealed cistern, 6 litres, pneumatic flush actuation

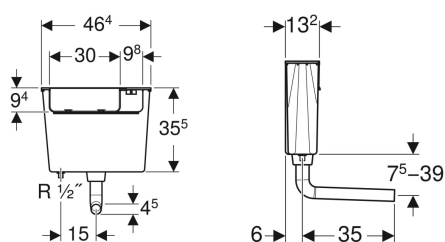

Example image



Application purposes

- For drywall construction
- For installation in bathroom furniture
- For installation in part-height prewall installations
- For low level installation
- For floor-standing WCs

Characteristics

- Flush actuation pneumatic
- Single flush

- Flush pipe connection with compression joint
- Cistern fulfils standard requirements in accordance with EN 14055, Class II
- Water supply connection on the bottom left
- Water supply connection 1/2"

Technical data

Flow pressure	0.1-10 bar
Maximum operating temperature, water	25 °C
Flush volume, factory setting	5.8 l

Scope of delivery

- Flush bend 90°
- Fastening for flush bend
- Cup for flush volume reduction 4.0 / 2.6 l
- Fastening material

Art. no.	B	H	T
109.721.00.2	46.4 cm	35.5 cm	13.2 cm



- Compatible with all pneumatic actuators
- The cistern can be operated with used water (rainwater) provided it is passed through a filter system first
- For single or dual flush

