

SPECIFICATION SHEET

COLLECTION: CELSIUS

PRODUCT CODE: DX-173252-CELSQ-CP



DESCRIPTION:

Celsius

- 3 outlet thermostatic shower valve
- Aquablade 200mm round head and shower arm
- Zoo single function shower kit with integrated outlet and bracket
- push type bath filler waste and overflow

thermostatic cartridge V-001C-PLA
diverter cartridge FL-804-33X/3X
minimum operating pressure
0.2 bar LP (shower) 1.0 bar MP (bath)

kit comprises:
CEL-1480/3/SQ-C/P
AOB-RO/20/SA-C/P
ZOO-SFMKW0-C/P
WG-81389-C/P

2 x 3/4" female inlets
3 x 3/4" female outlets
includes 3/4" - 1/2" adaptors
inc. bleed valve for system flush on installation
min-max wall mount 70-95mm
optimum installation depth 82mm

FINISH:

Chrome

FLOW REGULATOR:

FR-SHOWER/9-C/P (Shower Handset) FR-SHOWER/9-C/P (Fixed Shower Head)

MINIMUM OPERATING PRESSURE:

1.0 bar MP (bath) 0.2 bar LP (shower)



TECHNICAL DRAWING

COLLECTION: CELSIUS

PRODUCT CODE: DX-173252-CELSQ-CP

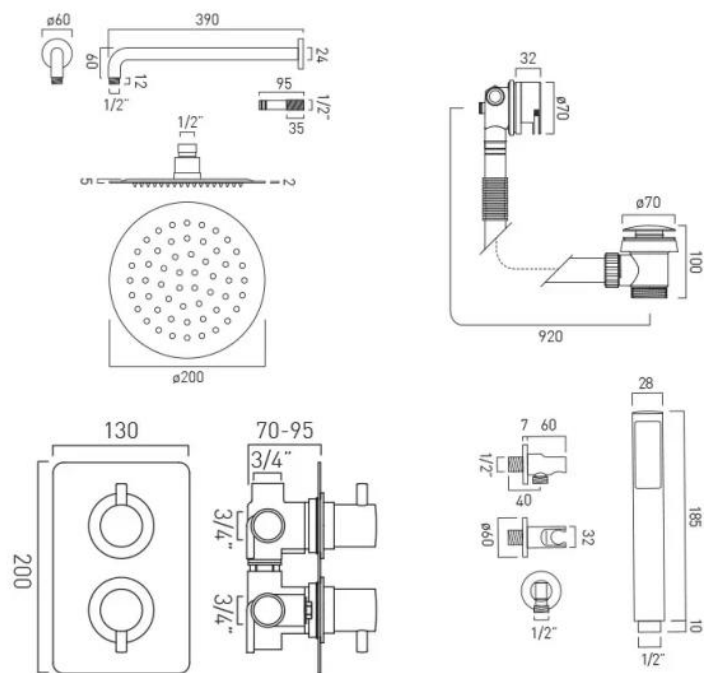

SPECIFICATION SHEET

COLLECTION: CELSIUS

PRODUCT CODE: CEL-148D/3/SQ-C/P



DESCRIPTION:

DX Celsius
concealed 3 outlet, 2 handle thermostatic
shower valve with integrated diverter
wall mounted
with rectangular backplate
thermostatic cartridge V-001C-PLA
diverter cartridge FL-804-33X/3X
2 x 3/4" female inlets
3 x 3/4" female outlets
includes 3/4" - 1/2" adaptors
inc. bleed valve for system flush on installation
min-max wall mount 70-95mm
optimum installation depth 82mm
minimum operating pressure 0.2 bar LP (shower)
minimum operating pressure 1.0 bar MP (bath)

FINISH:

Chrome

FLOW REGULATOR:

N

MINIMUM OPERATING PRESSURE:

0.2 bar LP (shower) 1.0 bar MP (bath)

FLOW RATE AT 3.0 BAR FLOW PRESSURE:

30 l/min

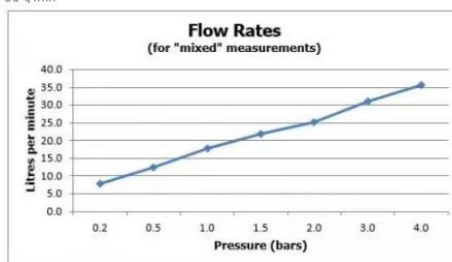

TECHNICAL DRAWING

COLLECTION: CELSIUS

PRODUCT CODE: CEL-148D/3/SQ-C/P

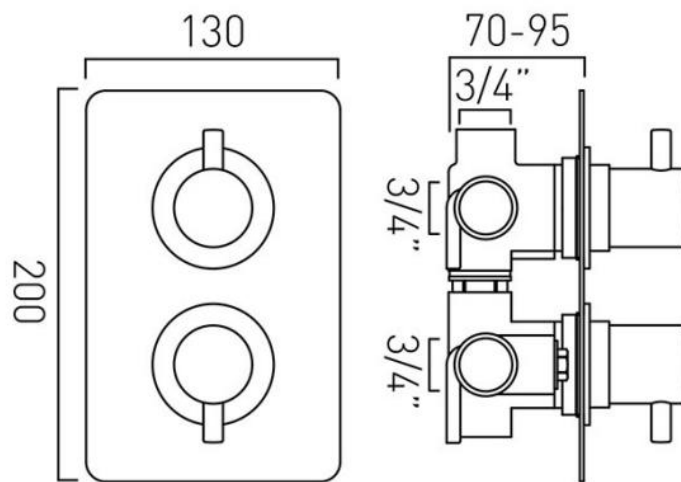

SPECIFICATION SHEET

COLLECTION: AQUABLADE

PRODUCT CODE: AQB-RO/20/SA-C/P



DESCRIPTION:

Aquablade
round slimline single function shower head
with shower arm
easy clean
wall mounted

200mm (8") diameter
minimum operating pressure 0.2 bar LP

FINISH:

Chrome

FLOW REGULATOR:

FR-SHOWER/9-C/P

MINIMUM OPERATING PRESSURE:

(8") 0.2 bar LP(12") 1.0 bar MP



TECHNICAL DRAWING

COLLECTION: AQUABLADE

PRODUCT CODE: AQB-R0/20/SA-C/P

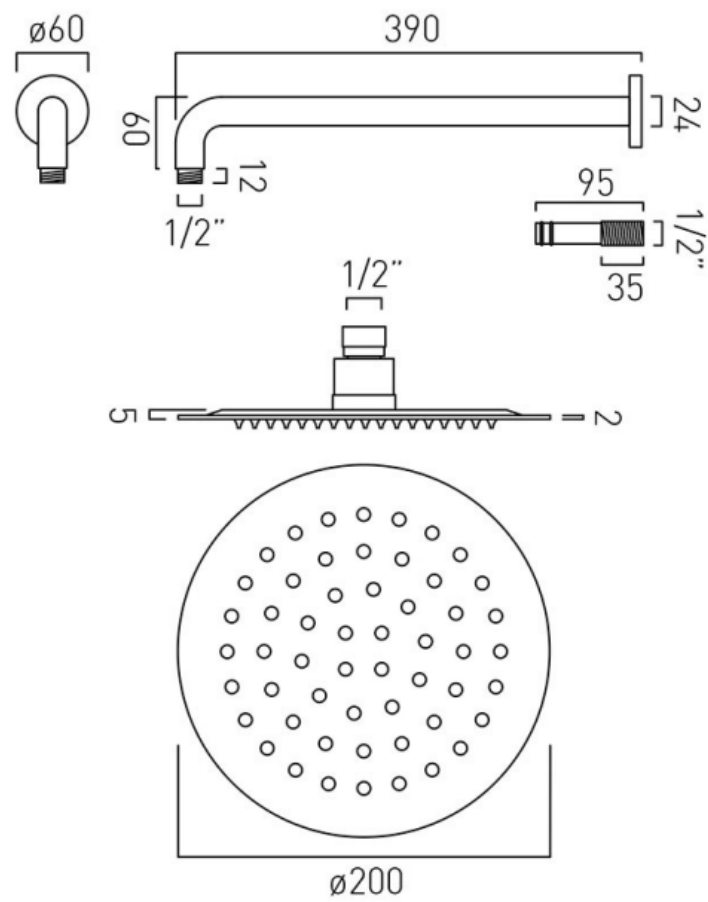

SPECIFICATION SHEET

COLLECTION: ZOO

PRODUCT CODE: ZOO-SFMKW0-C/P



DESCRIPTION:

Zoo
single function mini shower kit
wall mounted
with 150cm hose
and bracket with integrated outlet
1/2" inlet
minimum operating pressure 0.2 bar LP

FINISH:

Chrome

FLOW REGULATOR:

FR-SHOWER/9-C/P

MINIMUM OPERATING PRESSURE:

0.2 bar LP

FLOW RATE AT 3.0 BAR FLOW PRESSURE:

29 l/min

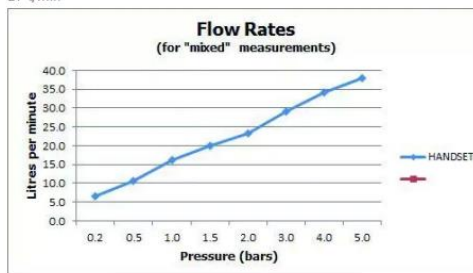

TECHNICAL DRAWING

COLLECTION: Z00

PRODUCT CODE: Z00-SFMKW0-C/P

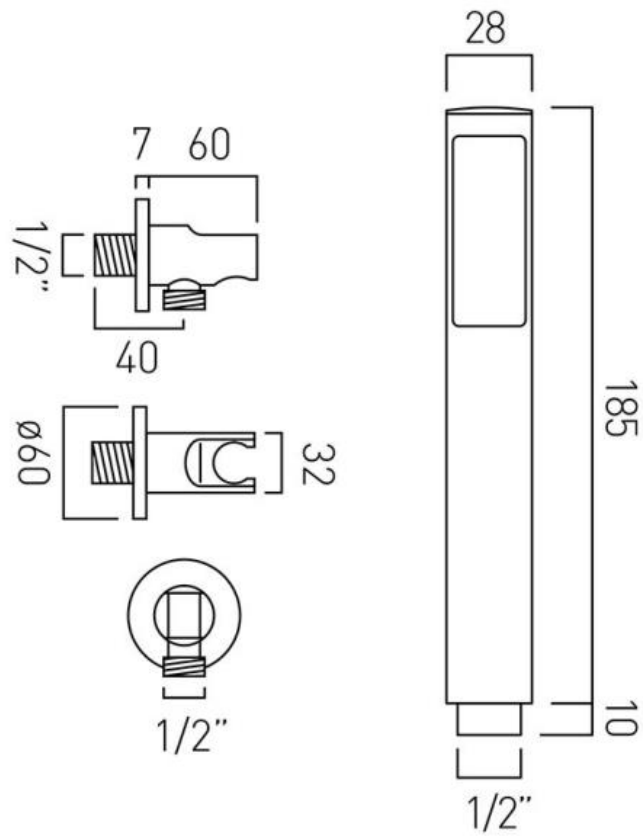

SPECIFICATION SHEET

COLLECTION:

PRODUCT CODE: WG-81389-C/P



DESCRIPTION:

push type bath filler waste and overflow
2 x 1/2" inlets (one is blanked off)
1.1/2" x 10mm threaded outlet connection
min-max overflow bath thickness 1mm-21mm
minimum operating pressure 1.0 bar MP

FINISH:

Chrome

MINIMUM OPERATING PRESSURE:

1.0 bar MP

FLOW RATE AT 3.0 BAR FLOW PRESSURE:

42 l/min

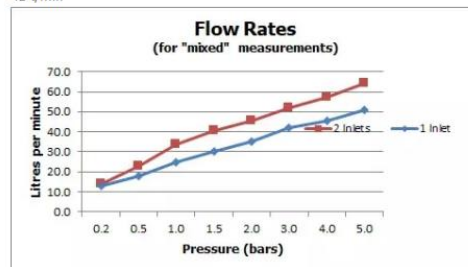

TECHNICAL DRAWING

COLLECTION:

PRODUCT CODE: WG-81389-C/P

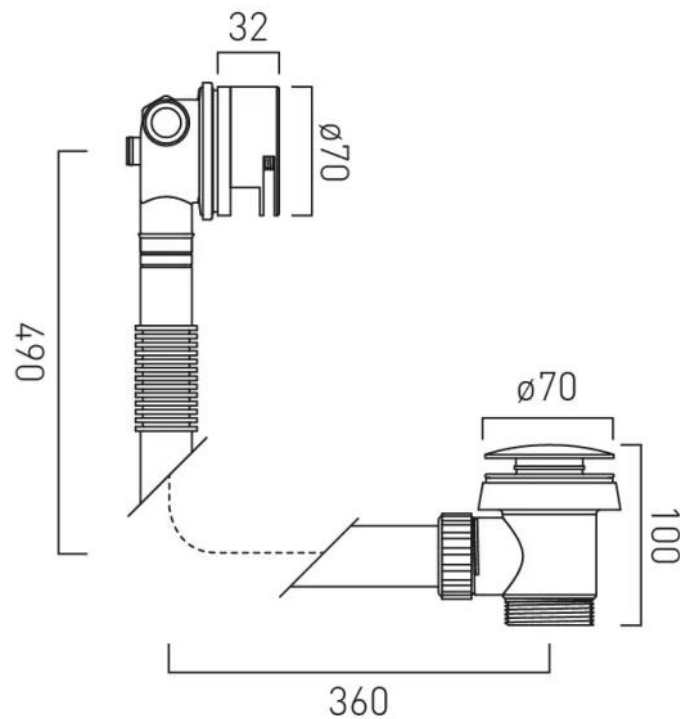

tel: 01934 744466
email: sales@vado.com
www.vado.com

where inspiration flows
taps | showering | accessories

